

N STRAIGHT MALE CLAMP ATTACHMENT FOR 1/4" SUPER FLEX CABLE

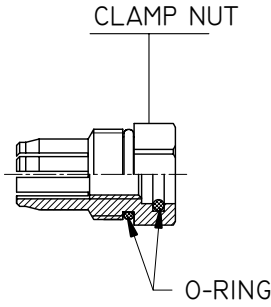

1

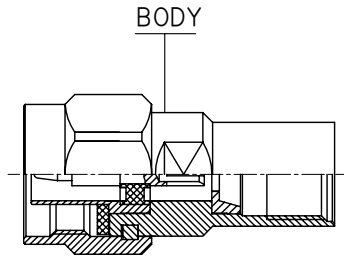
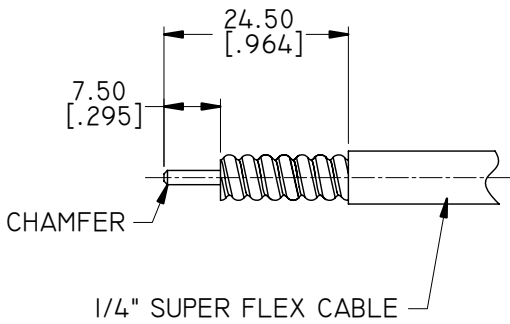

2

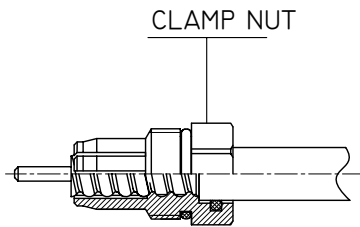

3

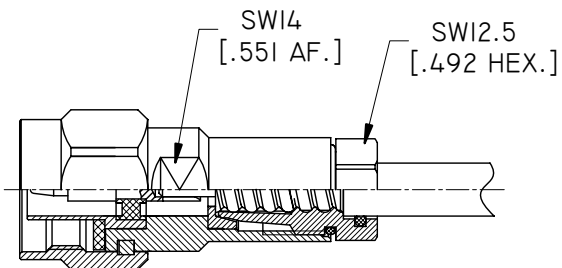

CONNECTOR	ANO 5111-2236
-----------	---------------

- 1.1 CUT THE OUTER CONDUCTOR AND DIELECTRIC OF THE WAVE AS SHOWN.
- 1.2 DEBURR OUTER CONDUCTOR AND MAKE A 0.5 [.02] CHAMFER ON CENTER CONDUCTOR.

- 2.1 ROTATE THE CLAMP NUT UNTIL IT BOTTOMS THE JACKET.

- 3.1 SCREW SUB-ASSEMBLY INTO THE CONNECTOR BODY. (RECOMMENDED COUPLING TORQUE 75.23 IN.LB - 8.5 NM).