

4 3 2 1

REVISIONS			
REV.	DESCRIPTION	DATE	APPROVED
A	INITIAL RELEASE	10/14/25	J Q

MATERIAL & FINISH:

- 2.92mm CONNECTOR:**
- 1 BODY: STAINLESS STEEL, PASSIVATED
 - 2 CENTER CONTACT: BERYLLIUM COPPER, GOLD PLATED
 - 3 INSULATOR: PEI

ELECTRICAL DATA:

- 1 IMPEDANCE: 50 Ω
- 2 FREQUENCY RANGE: 33~40GHz
- 3 VSWR: 1.30 MAX.
- 4 INSERTION LOSS: 0.5 dB MAX.

WR22:

- 1 CAVITY: BRASS, GOLD PLATED

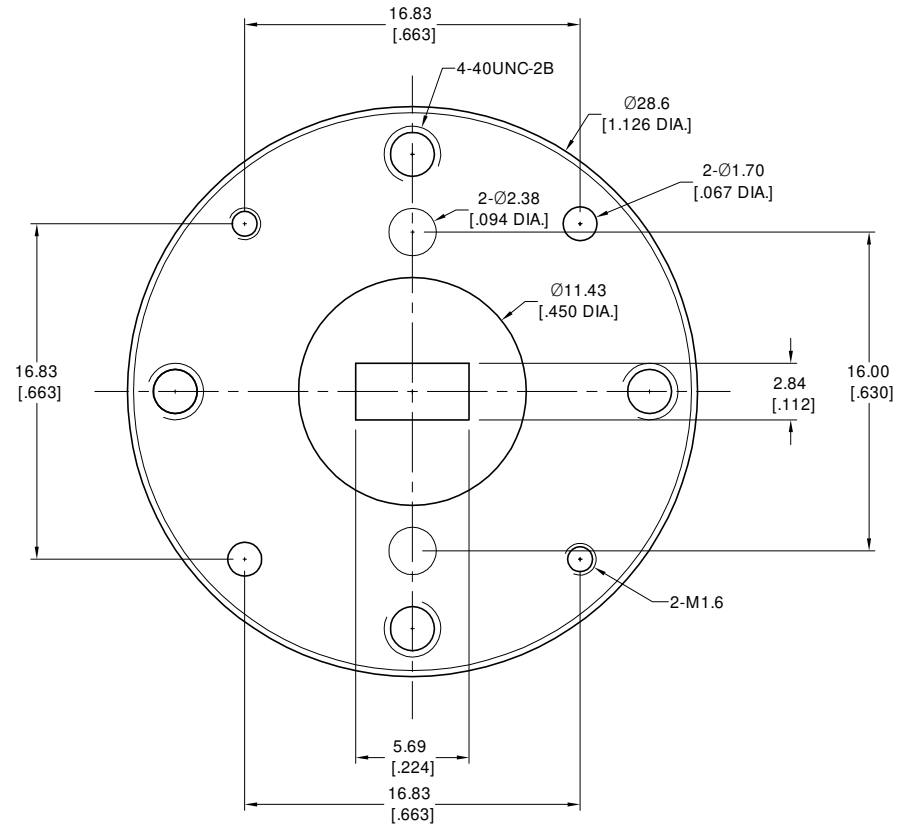
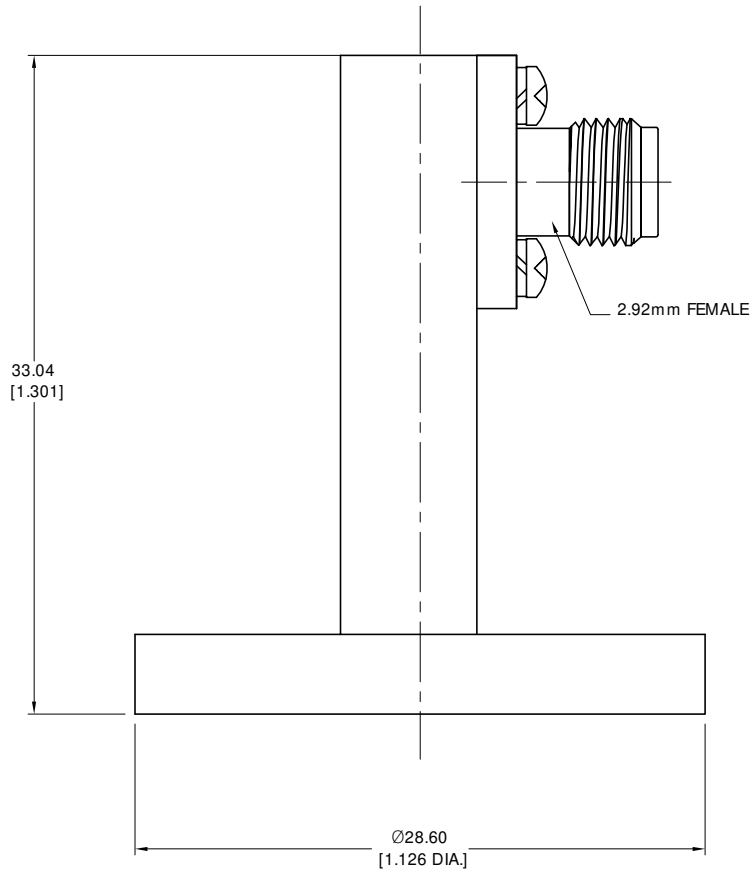

DRAWN	P. C	DATE	10/14/25
CHECKED	X. Y	DATE	10/14/25
APPROVED	J Q	DATE	10/14/25
UNLESS OTHERWISE SPECIFIED DIMENSIONS ARE IN MILLIMETERS, DIMENSIONS IN [] ARE IN INCHES FOR CUSTOMER REFERENCE ONLY UNLESS OTHERWISE SPECIFIED TOLERANCE ARE:		THESE DRAWINGS AND SPECIFICATIONS ARE THE PROPERTY OF ANOISON ELECTRONICS LTD AND SHOULD NOT BE USED WITHOUT WRITTEN PERMISSION COPYRIGHT © 2025 ANOISON ELECTRONICS LTD	
XX	±0.13 [0.005"]		
.X	±0.30 [0.012"]		
X	±0.50 [0.019"]		
.X°	±1°		
X°	±2°		



TITLE			
WR22 WAVEGUIDE TO COAXIAL 2.92mm ADAPTERS			
VIEW		PART NO.	
		WR22-292-01	
SIZE	SCALE	SHEET	REV.
A3	4:1	1/1	A

4 3 2 1