

VITA 67 & (Micro) D38999 Coax Assemblies





Anoison Electronics has the professional staff and engineers to create custom cable assemblies to meet our customers' needs. That is especially true when it comes to VITA67 and D38999 multi-coax connection systems.

Our experts can create VITA67 and D38999 coaxial assemblies using either of two major cable diameters 0.086 and 0.047 with working frequencies up to 65GHz.

Available connectors include 38999 contact, size-8 BMA, size-8 BMZ, size-12 SMPM and size-16 SMPS; VITA67 SMPM, SMPS & NanoRF. Further, Anoison

makes a wide range of standard connectors available including SMA/2.92mm/2.4mm/1.85mm/SMPM/SMPS connector series.

In order to address size and weight issues with traditional D38999 connectors, Anoison developed SMPS Size-16 coax for Micro38999 (Amphenol 2M805) connectors. Micro38999 is 50% smaller and 60% more contact density than traditional D38999 resulting in up to 70% weight savings and 50% size savings compared to traditional D38999.

Our VITA67 and D38999 cable assemblies assure the best mechanical strength by using the hardest available materials for the micro connector bodies.

Customers can specify precise lengths and Phase Matching as needed for their application.

Anoison designers and engineers are known for quickly turning detailed requirements into solutions. And our production staff assures quick delivery of the custom cables.

VITA 67 Cable Assemblies

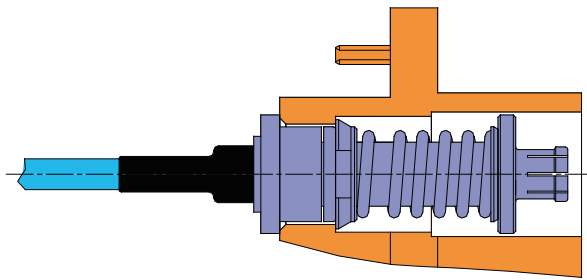

VITA 67.3 Backplane SMPM Contact

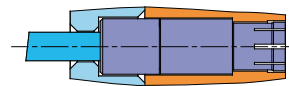

VITA 67.3 Plug-in NanoRF Contact

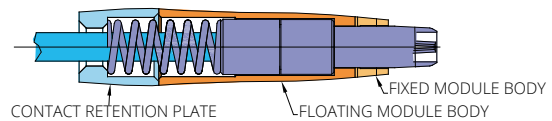

VITA 67.3 Backplane NanoRF Contact

VITA 67 Coaxial Cable Assembly Contacts

Std	Module Stl	Interface	Cable	Part number
VITA 67.1/2	Backplane	SMPM FEMALE	AFLEX047	ANO 9412-2038
VITA 67.1/2	Backplane	SMPM FEMALE	AFLEX086	ANO 9412-2050
VITA 67.1/2	Plug - in Card	SMPM MALE	AFLEX086	ANO 9411-2078
VITA 67.1/2	Plug - in Card	SMPM MALE	AFLEX047	ANO 9411-2081
VITA 67.1/2	Backplane	SMPM FEMALE	AFLEX086	ANO 9412-2038
VITA 67.3	Plug - in Card	SMPM MALE	AFLEX086	ANO 9411-2073
VITA 67.3	Plug - in Card	SMPM MALE	AFLEX047	ANO 9411-2080
VITA 67.3	Backplane	SMPM FEMALE	AFLEX086	ANO 9412-2044
VITA 67.3	Backplane	NanoRF FEMALE	AFLEX086	ANO 9412-2072
VITA 67.3	Backplane	SMPM FEMALE	AFLEX047	ANO 9412-2070
VITA 67.3	Backplane	SMPS FEMALE	AFLEX047	ANO 7812-2006
VITA 67.3	Plug - in Card	SMPS MALE	AFLEX047	ANO 7811-2017
VITA 67.3	Backplane	NanoRF FEMALE	AFLEX086	ANO 4112-2020
VITA 67.3	Plug - in Card	NanoRF MALE	AFLEX086	ANO 4111-2030
VITA 67.3	Backplane	NanoRF FEMALE	AFLEX047	ANO 4112-2026
VITA 67.3	Plug - in Card	NanoRF MALE	AFLEX047	ANO 4111-2021

Notes:

- 1) VITA67 and 38999 style connectors are available on another coax side along with standard SMP/SMPM/SMPS/SMA/2.92mm/2.4mm/1.85mm connectors.
- 2) Cable lengths are defined by users.
- 3) Advise if you have Phase-match demand.

SMPM Contacts Mated in D38999 Housing

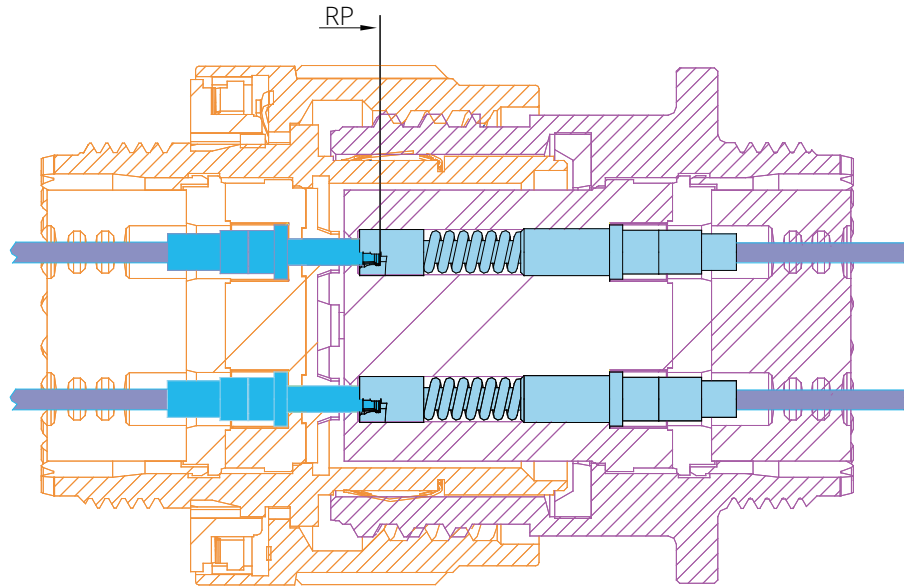

D38999 Coaxial Cable Assembly Contacts

Std	Size #	Interface	Cable	Part number
D38999	Size 8	BMA PLUG	AFLEX086	ANO 1411-2008
D38999	Size 8	BMA JACK	AFLEX086	ANO 1412-2009
D38999	Size 8	BMA PLUG	PLEX210	ANO 1411-2039
D38999	Size 8	BMA JACK	PLEX210	ANO 1412-2040
D38999	Size 8	BMA PLUG	AFLEX141	ANO 1411-2041
D38999	Size 8	BMA JACK	AFLEX141	ANO 1412-2042
D38999	Size 8	BMZ PLUG	AFLEX086	ANO 1411-2033
D38999	Size 8	BMZ JACK	AFLEX086	ANO 1412-2046
D38999	Size 8	BMZ PLUG	AFLEX141	ANO 1411-2045
D38999	Size 8	BMZ JACK	AFLEX141	ANO 1412-2034
D38999	Size 12	SMPM MALE	AFLEX086	ANO 9411-2037
D38999	Size 12	SMPM FEMALE	AFLEX086	ANO 9412-2043
D38999	Size 12	SMPM MALE	AFLEX047	ANO 9411-2060
D38999	Size 16	SMPS MALE	AFLEX047	ANO 7811-2005
D38999	Size 16	SMPS FEMALE	AFLEX047	ANO 7812-2004

Notes:

- 1) VITA67 and 38999 style connectors are available on another coax side along with standard SMP/SMPM/SMPS/SMA/2.92mm/2.4mm/1.85mm connectors.
- 2) Cable lengths are defined by users.
- 3) Advise if you have Phase-match demand.



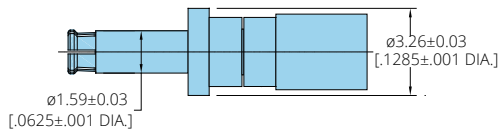

SMPS Female Contact for 2M805

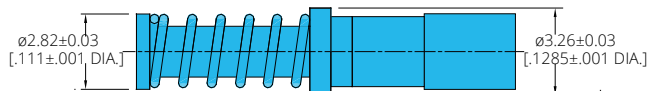

SMPS Male Contact for 2M805

2M805(Micro38999) Coaxial Cable Assembly Contacts

Std	Size #	Interface	Cable	Part number
2M805 (MICRO 38999)	Size 16	SMPS FEMALE	AFLEX047	ANO 7812-2004
2M805 (MICRO 38999)	Size 16	SMPS MALE	AFLEX047	ANO 7811-2008
2M805 (MICRO 38999)	Size 16	SMPS FEMALE	AFLEX086	ANO 7812-2011
2M805 (MICRO 38999)	Size 16	SMPS MALE	AFLEX086	ANO 7811-2010



Contact

United States:

PO Box 1562
 Dripping Springs, Texas 78620, USA
 Toll Free: 800-537-0680
 Email: info@anoison.com
 web: www.anoison.com

APAC Office:

5F, Bashamichi DOMON Building
 4-53-2, Bentendori, Naka-ku
 Yokohama, Kanagawa 231-0007, Japan
 Tel: +81-45-228-9352
 E-Mail: toshi.sasaki@anoison.com