

4 3 2 1

MATERIAL & FINISH:

- 1 BODY: STAINLESS STEEL, PASSIVATED
- 2 CENTER CONTACT: BERYLLIUM COPPER ALLOY, GOLD PLATED
- 3 INSULATOR: PEI

ENVIRONMENTAL DATA:

- 1 TEMPERATURE RANGE: -55°C~+125°C
- 2 2011/65/EU (RoHS): COMPLIANT

ELECTRICAL SPECIFICATIONS:

- 1 IMPEDANCE: 50 Ω
- 2 FREQUENCY RANGE: DC~40GHz
- 3 VSWR: 1.20 MAX.
- 4 INSERTION LOSS: 0.4 DB MAX.

REVISIONS			
REV.	DESCRIPTION	DATE	APPROVED
A	INITIAL RELEASE	04/29/14	J. QU
B	PART NO. CHANGED	05/29/15	J. QU
C	SW8 [.315 HEX.] WAS SW 6 [.236 AF.]	06/07/17	J. QU
D	ADDED INSERTION LOSS	09/18/21	J. QU

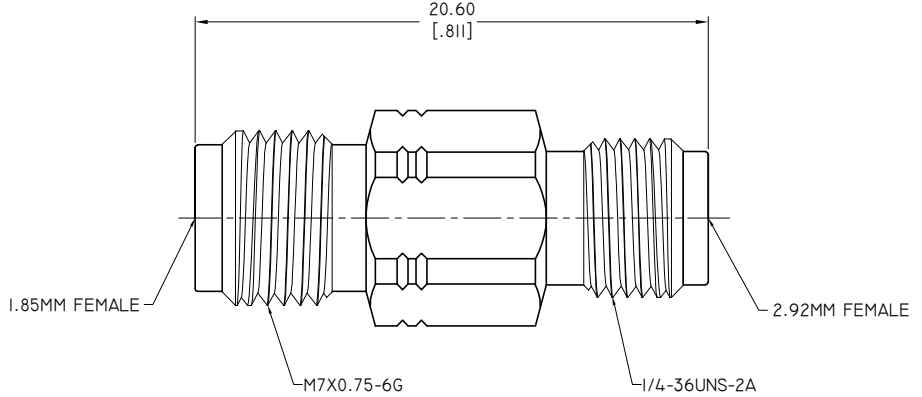
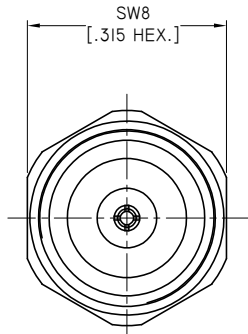

DRAWN	X. B. YANG	DATE	09/18/21
CHECKED	W. YANG	DATE	09/18/21
APPROVED	J. QU	DATE	09/18/21
UNLESS OTHERWISE SPECIFIED DIMENSIONS ARE IN MILLIMETERS, DIMENSIONS IN [] ARE IN INCHES FOR CUSTOMER REFERENCE ONLY UNLESS OTHERWISE SPECIFIED TOLERANCE ARE:		THESE DRAWINGS AND SPECIFICATIONS ARE THE PROPERTY OF ANOISON ELECTRONICS LTD AND SHOULD NOT BE USED WITHOUT WRITTEN PERMISSION COPYRIGHT © 2021 ANOISON ELECTRONICS LTD	
.XX	±0.13 [.005"]		
.X	±0.20 [.008"]		
X	±0.50 [.019"]		
X°	±1°		
X"	±2°		



TITLE
PRECISION ADAPTER, 1.85MM FEMALE TO 2.92MM FEMALE

VIEW	PART NO. PA6229C		
	SIZE A3	SCALE 5:1	SHEET 1/1
		REV. D	

4 3 2 1