

REVISIONS			
REV.	DESCRIPTION	DATE	APPROVED
A	INITIAL RELEASE	09/11/25	J. Q

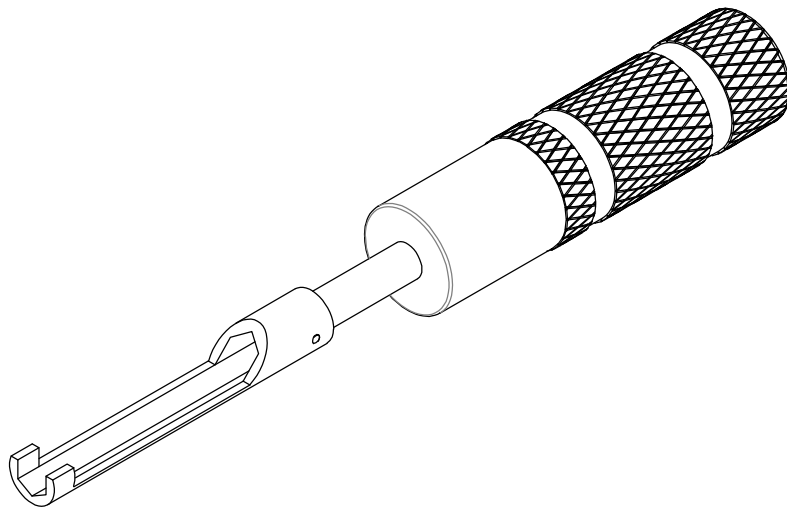
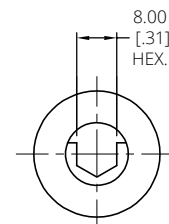
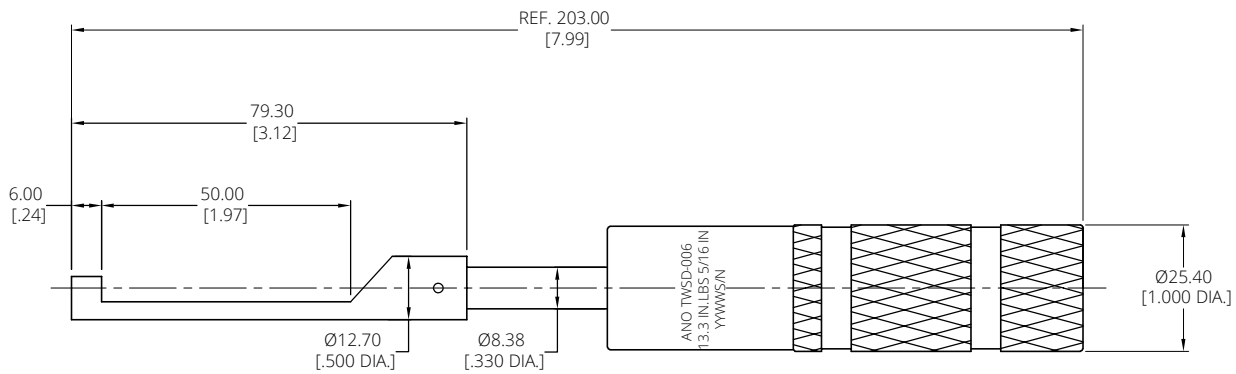

- TORQUE VALUE: 1.5±0.07 NM [13.30±0.6 IN.LBS]
- SIZE: 8.0 MM [5/16 IN.]

DRAWN	X. Y	DATE	09/11/25
CHECKED	W. Y	DATE	09/11/25
APPROVED	J. Q	DATE	09/11/25
UNLESS OTHERWISE SPECIFIED DIMENSIONS ARE IN MILLIMETERS, DIMENSIONS IN [] ARE IN INCHES FOR CUSTOMER REFERENCE ONLY UNLESS OTHERWISE SPECIFIED TOLERANCE ARE:		THESE DRAWINGS AND SPECIFICATIONS ARE THE PROPERTY OF ANOISON ELECTRONICS LTD AND SHOULD NOT BE USED WITHOUT WRITTEN PERMISSION COPYRIGHT © 2025 ANOISON ELECTRONICS LTD	
XX	±0.13 [.005"]		
X	±0.20 [.008"]		
X	±0.50 [.019"]		
X*	±1°		
X*	±2°		

TITLE
TORQUE WRENCH IN SCREWDRIVER TYPE
PRESET TORQUE= 1.5±0.07 NM [13.30±0.6 IN.LBS]
HEX SIZE 8.0 MM [5/16 IN.]

VIEW		PART NO. ANO TWSD-006
SIZE A3	SCALE 1:1	SHEET 1/1
REV. A		