

4

3

2

1

REVISIONS			
REV.	DESCRIPTION	DATE	APPROVED
A	INITIAL RELEASE	01/08/16	J. QU

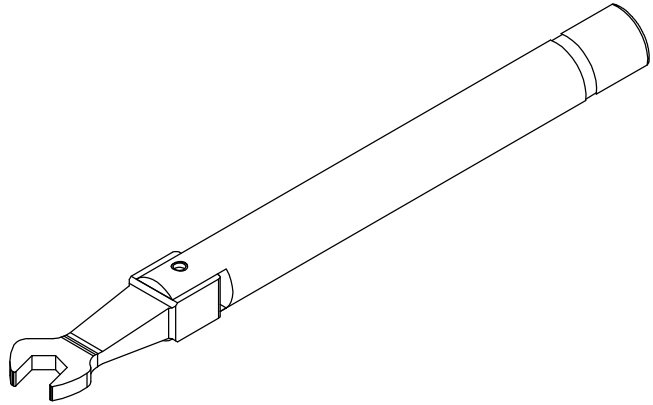
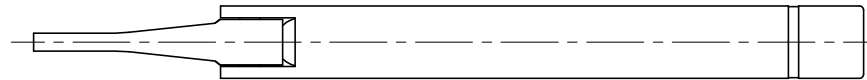
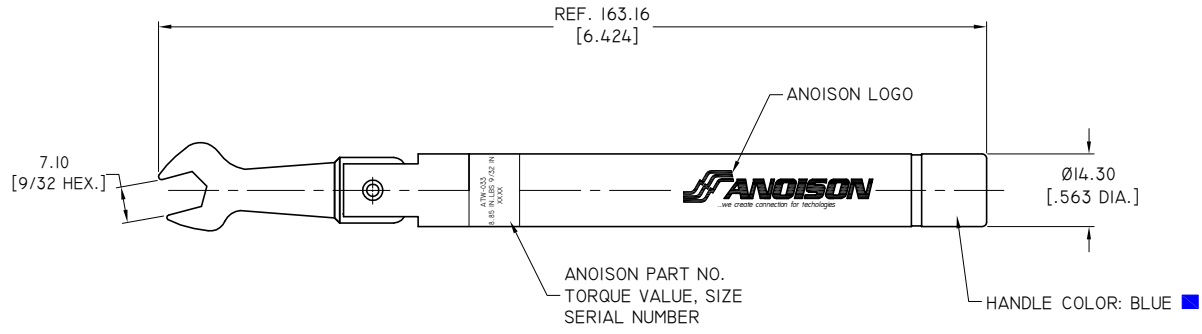

1. TORQUE VALUE: 1.0±0.04 NM [8.85±0.35 IN.LBS]
2. SIZE: 7.10 MM [9/32 IN.]
3. PRINT CONTENT ON HANDLE(WHITE COLOR): ANOISON LOGO

DRAWN	L. YANG	DATE	01/08/16
CHECKED	X. B. YANG	DATE	01/08/16
APPROVED	J. QU	DATE	01/08/16
UNLESS OTHERWISE SPECIFIED DIMENSIONS ARE IN MILLIMETERS, DIMENSIONS IN [] ARE IN INCHES FOR CUSTOMER REFERENCE ONLY UNLESS OTHERWISE SPECIFIED		THESE DRAWINGS AND SPECIFICATIONS ARE THE PROPERTY OF ANOISON ELECTRONICS LTD AND SHOULD NOT BE USED WITHOUT WRITTEN PERMISSION	
TOLERANCE ARE:		COPYRIGHT © 2016 ANOISON ELECTRONICS LTD	
.XX	±0.13 [.005"]		
.X	±0.20 [.008"]		
X	±0.50 [.019"]		
.X°	±1°		
X°	±2°		



TITLE			
TORQUE WRENCH FOR SMA TYPE CONNECTORS PRESET TORQUE= 1.0±0.04 NM [8.85±0.35 IN.LBS] HEX SIZE 7.10 MM [9/32 IN.]			
VIEW		PART NO.	
		ANO TW-033	
SIZE	SCALE	SHEET	REV.
A3	1:1	1/1	A

4

3

2

1