

1.0 MATERIAL & FINISH:

- 1.1 CENTER CONTACT: BERYLLIUM COPPER ALLOY, GOLD PLATED
- 1.2 INSULATOR: PTFE & PEI
- 1.3 BODY 1: STAINLESS STEEL, PASSIVATED
- 1.4 BODY 2: BERYLLIUM COPPER ALLOY, GOLD PLATED

2.0 ENVIRONMENTAL DATA:

- 2.1 TEMPERATURE RANGE: -55°C~+155°C
- 2.2 2011/65/EU (RoHS): COMPLIANT

ELECTRICAL DATA:

- 1. IMPEDANCE: 50 Ω
- 2. FREQUENCY RANGE: DC~26.5GHz
- 3. VSWR: 1.20 MAX. AT DC~18GHz
1.35 MAX. AT 18GHz~26.5GHz
- 4. DIELECTRIC WITHSTANDING VOLTAGE: 500 V MAX.

REVISIONS			
REV.	DESCRIPTION	DATE	APPROVED
A	INITIAL RELEASE	02/10/17	J. QU

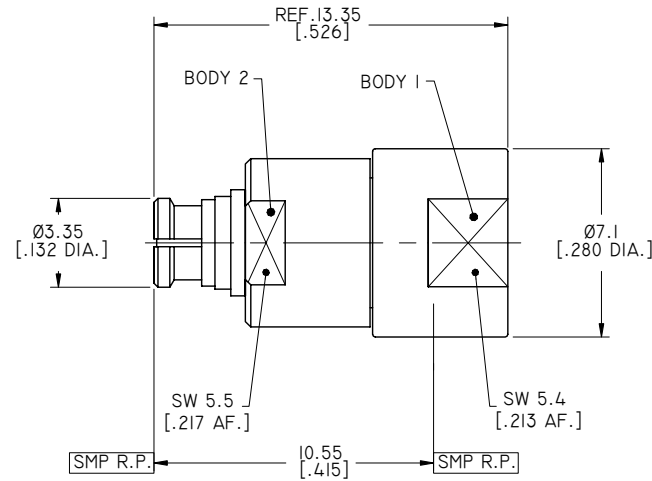

P/N	TYPE
ANO 932-931-I391-1	FULL DETENT
ANO 932-931-I391-2	LIMITED DETENT

DRAWN	P. CHEN	DATE	02/10/17
CHECKED	L. YANG	DATE	02/10/17
APPROVED	J. QU	DATE	02/10/17
UNLESS OTHERWISE SPECIFIED DIMENSIONS ARE IN MILLIMETERS, DIMENSIONS IN [] ARE IN INCHES FOR CUSTOMER REFERENCE ONLY UNLESS OTHERWISE SPECIFIED TOLERANCE ARE:		THESE DRAWINGS AND SPECIFICATIONS ARE THE PROPERTY OF ANOISON ELECTRONICS LTD AND SHOULD NOT BE USED WITHOUT WRITTEN PERMISSION COPYRIGHT © 2017 ANOISON ELECTRONICS LTD	
.XX	±0.13 [.005"]		
.X	±0.20 [.008"]		
X	±0.50 [.019"]		
.X°	±1°		
X°	±2°		



TITLE			
ADAPTER, SMP FEMALE TO SMP MALE			
VIEW		PART NO.	
		ANO 932-931-I391	
SIZE	SCALE	SHEET	REV.
A3	5:1	1/1	A