

4 3 2 1

REVISIONS			
REV.	DESCRIPTION	DATE	APPROVED
A	INITIAL RELEASE	01/08/18	J. Q
B	ADDED TABLES	01/07/22	J. Q
C	FREQUENCY CHANGED	04/10/24	J. Q

**1.0 MATERIAL & FINISH:**

- 1.1 BODY: STAINLESS STEEL, PASSIBATED
- 1.2 CENTER CONTACT: BERYLLIUM COPPER ALLOY, GOLD PLATED
- 1.3 INSULATOR: PTFE

**2.0 ELECTRICAL DATA:**

- 2.1 IMPEDANCE: 50 Ω
- 2.2 FREQUENCY RANGE: DC~24GHZ

**3.0 ENVIRONMENTAL DATA:**

- 3.1 TEMPERATURE RANGE: -55°C~+125°C
- 3.2 2011/65/EU (RoHS): COMPLIANT

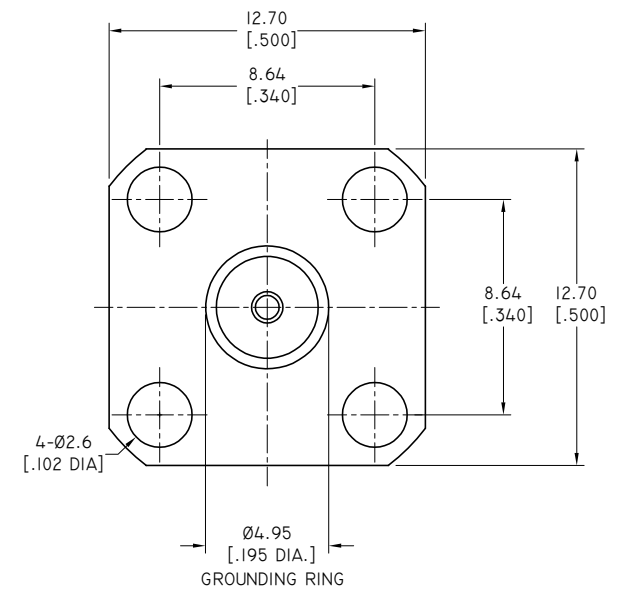
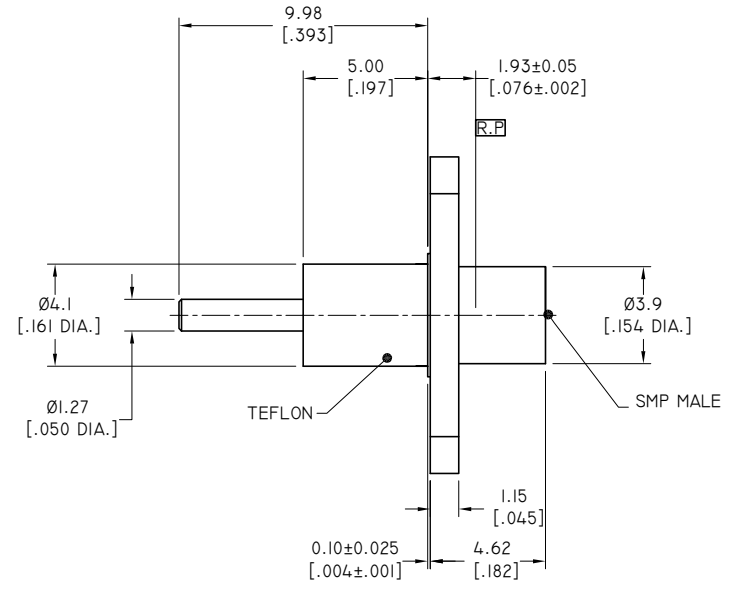

PART NO.	TYPE
ANO 9311-3080-1	FULL DETENT
ANO 9311-3080-2	LIMITED DETENT
ANO 9311-3080-3	SMOOTH BORE

DRAWN	P. C	DATE	04/10/24
CHECKED	X. Y	DATE	04/10/24
APPROVED	J. Q	DATE	04/10/24
UNLESS OTHERWISE SPECIFIED DIMENSIONS ARE IN MILLIMETERS, DIMENSIONS IN [ ] ARE IN INCHES FOR CUSTOMER REFERENCE ONLY UNLESS OTHERWISE SPECIFIED TOLERANCE ARE:		THESE DRAWINGS AND SPECIFICATIONS ARE THE PROPERTY OF ANOISON ELECTRONICS LTD AND SHOULD NOT BE USED WITHOUT WRITTEN PERMISSION COPYRIGHT © 2024 ANOISON ELECTRONICS LTD	
.XX	±0.13 [.005"]		
.X	±0.20 [.008"]		
X°	±0.50 [.019"]		
X°	±1°		
X°	±2°		

**TITLE**  
SMP STRAIGHT MALE, 4 HOLE  
FLANGE PANEL MOUNT RECEPTACLE

**VIEW**

**PART NO.**  
ANO 9311-3080

<b>SIZE</b> A3	<b>SCALE</b> 5:1	<b>SHEET</b> 1/1	<b>REV.</b> C
-------------------	---------------------	---------------------	------------------

4 3 2 1