

4

3

2

1

MATERIAL & FINISH

- 1 BODY: BRASS, GOLD PLATED
- 2 CENTER CONTACT: BERYLLIUM COPPER ALLOY, GOLD PLATED
- 3 COUPLING NUT: BRASS, GOLD PLATED
- 4 INSULATOR: PTFE
- 5 RESISTANCE: BERYLLIUM OXIDE

ELECTRICAL DATA:

- 1 IMPEDANCE: 50 OHMS
- 2 FREQUENCY RANGE: DC~6 GHZ
- 3 VSWR: 1.25 MAX.
- 4 AVERAGE POWER: 1 WATT AVERAGE TO 25°C AMBIENT TEMPERATRUE, DERATED LINEARLY TO 0.1 W @ 125°C
- 5 PEAK POWER: 0.1 KW (5μS PULSE WIDTH WITH 0.5% DUTY CYCLE)

ENVIRONMENTAL DATA:

- 1 OPERATING TEMPERATURE RANGE: -55°C~+125°C
- 2 2011/65/EU(RoHS) AND 2015/863/(RoHS): COMPLIANT
- 3 1999/45/EC(REACH): COMPLIANT

REVISIONS			
REV.	DESCRIPTION	DATE	APPROVED
A	INITIAL RELEASE	03/01/19	J. QU
B	Ø6.35 [.250 DIA.] WSA Ø5.60 [.220 DIA.]	03/05/19	J. QU

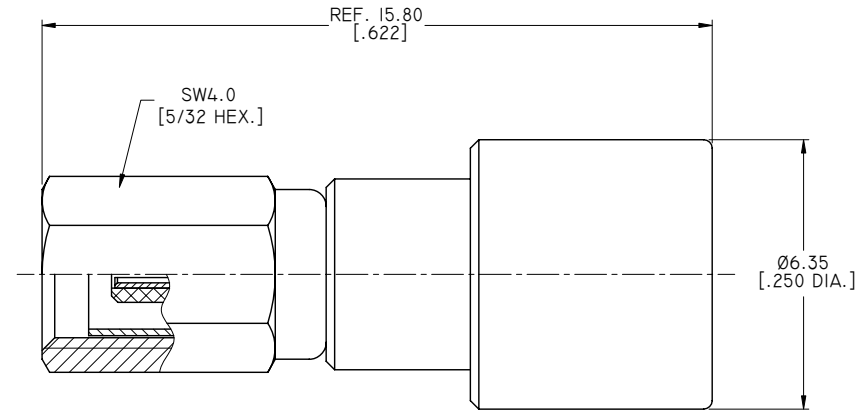

DRAWN	X. B. YANG	DATE	03/05/19
CHECKED	W. YANG	DATE	03/05/19
APPROVED	J. QU	DATE	03/05/19
UNLESS OTHERWISE SPECIFIED DIMENSIONS ARE IN MILLIMETERS, DIMENSIONS IN [] ARE IN INCHES FOR CUSTOMER REFERENCE ONLY UNLESS OTHERWISE SPECIFIED TOLERANCE ARE:		THESE DRAWINGS AND SPECIFICATIONS ARE THE PROPERTY OF ANOISON ELECTRONICS LTD AND SHOULD NOT BE USED WITHOUT WRITTEN PERMISSION COPYRIGHT © 2019 ANOISON ELECTRONICS LTD	
.XX	±0.13 [.005"]		
.X	±0.20 [.008"]		
X	±0.50 [.019"]		
.X°	±1°		
X°	±2°		



TITLE			
COAXIAL TERMINATION SSMC PLUG, 1 WATT, DC~6GHZ			
VIEW		PART NO.	
		ANO 748-101	
SIZE	SCALE	SHEET	REV.
A3	8:1	1/1	B

4

3

2

1