

MATERIAL & FINISH

- 1 BODY: STAINLESS STEEL, PASSIVATED
- 2 CENTER CONTACT: BERYLLIUM COPPER ALLOY, GOLD PLATED
- 3 COUPLING NUT: STAINLESS STEE, PASSIVATED
- 4 RETAINING RING: BERYLLIUM COPPER ALLOY, UNPLATED
- 5 INSULATOR: PTFE & PEI
- 6 RESISTANCE: BERYLLIUM OXIDE

ENVIRONMENTAL DATA:

- 1 TEMPERATURE RANGE: -55°C~+125°C
- 2 2011/65/EU(RoHS) AND 2015/863/(RoHS): COMPLIANT
- 3 1999/45/EC(REACH): COMPLIANT

ELECTRICAL DATA:

- 1 IMPEDANCE: 50 OHMS
- 2 FREQUENCY RANGE: DC~18 GHZ
- 3 VSWR: 1.05 MAX. AT DC~4 GHZ
1.10 MAX. AT 4~8 GHZ
1.15 MAX. AT 8~12.4 GHZ
1.20 MAX. AT 12.4~18 GHZ
- 4 AVERAGE POWER: 2 W AVERAGE, POWER DERATED LINEARLY FROM +45°C TO <10% @ +125°C
- 5 PEAK POWER: 500 W (5μS SEC PW, <1% DUTY CYCLE)

REVISIONS			
REV.	DESCRIPTION	DATE	APPROVED
A	INITIAL RELEASE	04/08/19	J. QU
B	1. 13.13 [.517] WAS 14.00 [.551] 2. Ø6.35 [.250 DIA.] WAS Ø6.45 [.254 DIA.]	04/09/19	J. QU

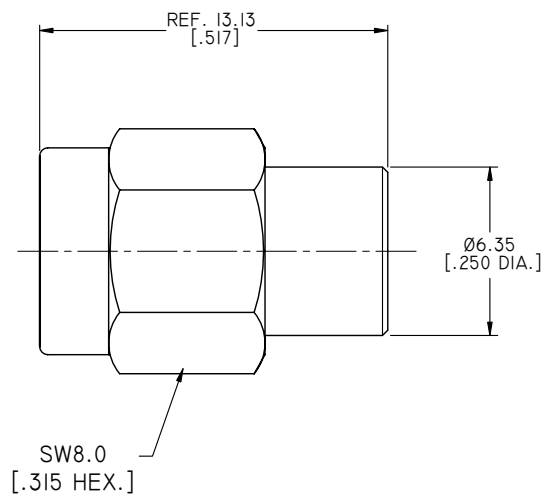

NOTES:

- 1 ALL SPECIFICATIONS ARE SUBJECT TO CHANGE WITHOUT NOTICE AT ANY TIME.
- 2 CUSTOMER OUTLINE DRAWING FOR REFERENCE ONLY.

DRAWN	X. B. YANG	DATE	04/09/19
CHECKED	W. YANG	DATE	04/09/19
APPROVED	J. QU	DATE	04/09/19
UNLESS OTHERWISE SPECIFIED DIMENSIONS ARE IN MILLINMETERS, DIMENSIONS IN [] ARE IN INCHES FOR CUSTOMER REFERENCE ONLY UNLESS OTHERWISE SPECIFIED TOLERANCE ARE:		THESE DRAWINGS AND SPECIFICATIONS ARE THE PROPERTY OF ANOISON ELECTRONICS LTD AND SHOULD NOT BE USED WITHOUT WRITTEN PERMISSION COPYRIGHT © 2019 ANOISON ELECTRONICS LTD	
.XX	±0.13 [.005"]		
.X	±0.20 [.008"]		
X	±0.50 [.019"]		
.X°	±1°		
X°	±2°		



TITLE			
COAXIAL TERMINATION SMA MALE, 2 WATTS, DC-18 GHZ			
VIEW		PART NO.	
		ANO 721-I23	
SIZE	SCALE	SHEET	REV.
A3	5:1	1/1	B