

**MATERIAL & FINISH:**

1. BODY: STAINLESS STEEL, PASSIVATED
2. CENTER CONTACT: BERYLLIUM COPPER ALLOY, GOLD PLATED
3. INSULATOR: PEI/PTFE

**ENVIRONMENTAL DATA:**

1. TEMPERATURE RANGE: -55°C~+165°C
2. 2011/65/EC (RoHS): COMPLIANT

**ELECTRICAL DATA:**

1. IMPEDANCE: 50 Ω
2. FREQUENCY RANGE: DC~18 GHZ
3. VSWR: 1.25 MAX.

**MECHANICAL DATA:**

1. MECHANICAL DURABILITY: 500 CYCLES MIN.

REVISIONS			
REV.	DESCRIPTION	DATE	APPROVED
A	INITIAL RELEASE	05/08/15	J. QU

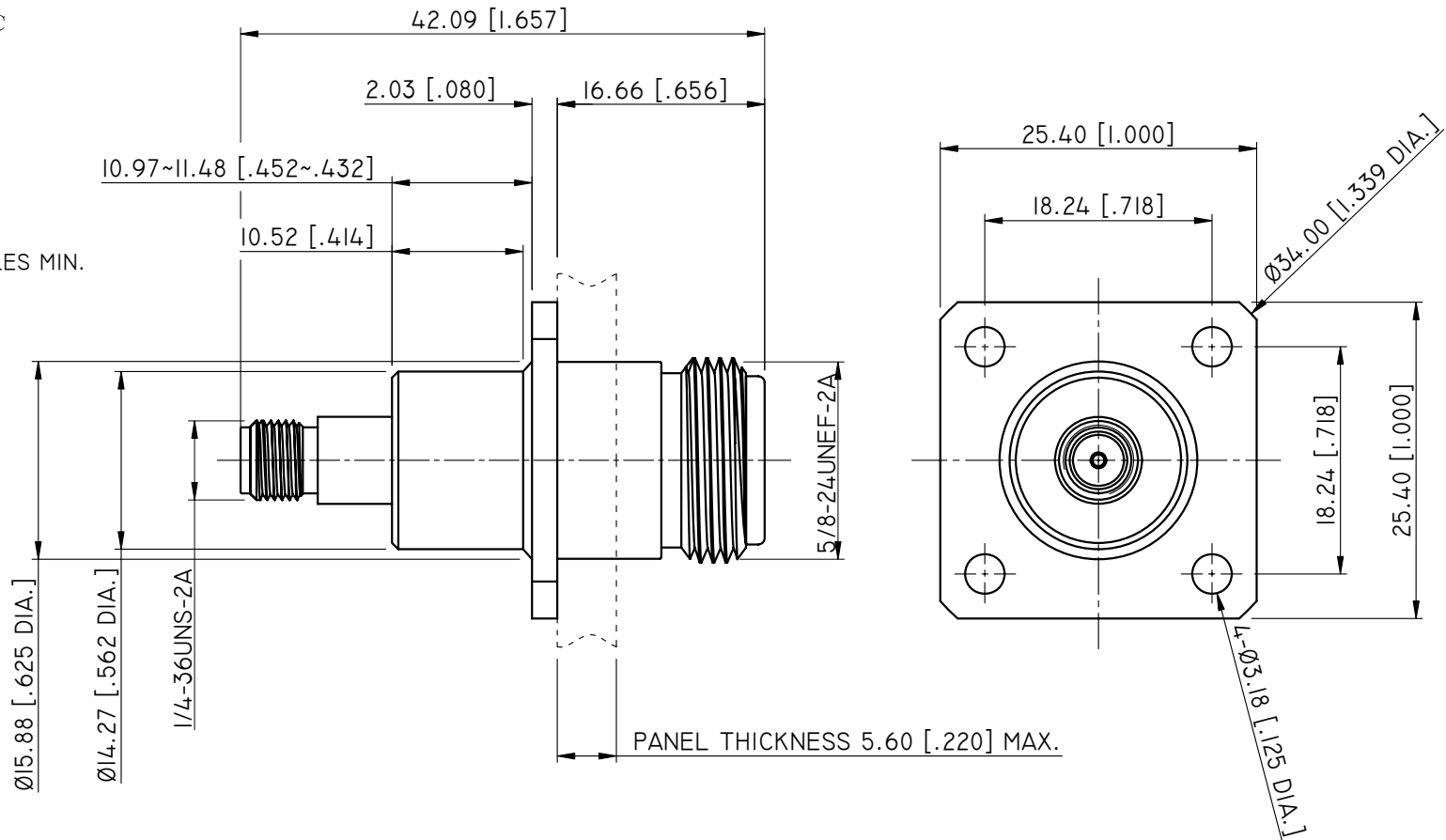

DRAWN	X. B. YANG	DATE	05/08/15										
CHECKED	L. YANG	DATE	05/08/15										
APPROVED	J. QU	DATE	05/08/15										
<small>UNLESS OTHERWISE SPECIFIED DIMENSIONS ARE IN MILLIMETERS, DIMENSIONS IN [ ] ARE IN INCHES FOR CUSTOMER REFERENCE ONLY UNLESS OTHERWISE SPECIFIED TOLERANCE ARE:</small>				<small>THESE DRAWINGS AND SPECIFICATIONS ARE THE PROPERTY OF ANOISON ELECTRONICS LTD AND SHOULD NOT BE USED WITHOUT WRITTEN PERMISSION COPYRIGHT © 2015 ANOISON ELECTRONICS LTD</small>									
<table border="0"> <tr> <td>.XX</td> <td>±0.13 [.005"]</td> </tr> <tr> <td>.X</td> <td>±0.20 [.008"]</td> </tr> <tr> <td>X</td> <td>±0.50 [.019"]</td> </tr> <tr> <td>.X°</td> <td>±1°</td> </tr> <tr> <td>X°</td> <td>±2°</td> </tr> </table>					.XX	±0.13 [.005"]	.X	±0.20 [.008"]	X	±0.50 [.019"]	.X°	±1°	X°
.XX	±0.13 [.005"]												
.X	±0.20 [.008"]												
X	±0.50 [.019"]												
.X°	±1°												
X°	±2°												
TITLE				ADAPTER, N FEMALE TO SMA FEMALE, 4 HOLES FLANGE									
VIEW		PART NO. ANO 512-212-I307											
		SIZE	SCALE	SHEET	REV.								
		A3	2.5:1	1/1	A								