

MATERIAL

- 1. BODY: BRASS
- 2. CENTER CONTACT: BRASS
- 3. INSULATOR: PTFE
- 4. OUTER CONTACT: PHOSPHOR BRONZE
- 5. COUPLING NUT: BRASS
- 6. CRIMP FERRULE: COPPER

FINISH

- 1. BODY: NICKEL
- 2. CENTER CONTACT: GOLD
- 3. OUTER CONTACT: NICKEL
- 4. COUPLING NUT: NICKEL
- 5. CRIMP FERRULE: NICKEL

ENVIRONMENTAL DATA:

- 1. TEMPERATURE RANGE: -55°C~+125°C
- 2. 2002/95/EC (RoHS): COMPLIANT

ELECTRICAL SPECIFICATIONS:

- 1. IMPEDANCE: 75 Ω
- 2. FREQUENCY RANGE: DC~1GHZ

REVISIONS			
REV.	DESCRIPTION	DATE	APPROVED

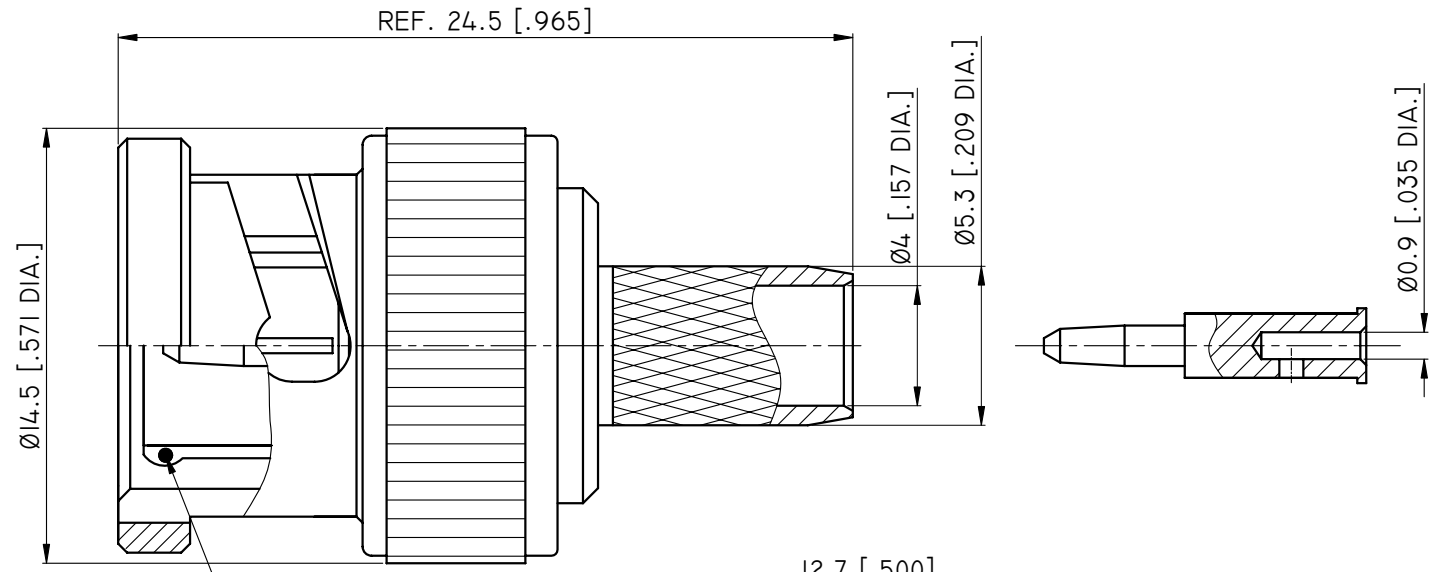

Outer Contact

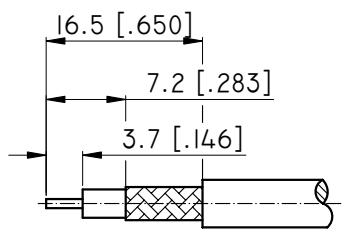

CABLE STRIPPING DIMENSIONS

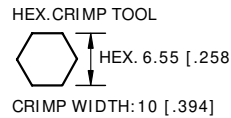

DRAWN	L. YANG	DATE	11/06/13
CHECKED	X. B. YANG	DATE	11/06/13
APPROVED	J. QU	DATE	11/06/13
UNLESS OTHERWISE SPECIFIED DIMENSIONS ARE IN MILLINETERS DIMENSIONS IN [] ARE IN INCHES FOR CUSTOMER REFERENCE ONLY UNLESS OTHERWISE SPECIFIED TOLERANCE ARE:			
	.XX	±0.13	[.005"]
	.X	±0.20	[.008"]
	X	±0.50	[.019"]
	.X°	±1°	
	X°	±2°	



TITLE			
BNC 75Ω STRAIGHT MALE CRIMP FOR RG59			
VIEW		PART NO.	
		ANO 4001-2006	
SIZE	SCALE	SHEET	REV.
A3	5:1	1/1	A