

4

3

2

1

MATERIAL & FINISH

- 1 REAR BODY: SEE TABLE
- 2 PRESS RING: SEE TABLE
- 3 COIL SPRING: MUSIC WIRE
- 4 DIELECTRIC: PTFE
- 5 FRONT BODY: BERYLLIUM COPPER ALLOY, GOLD PLATED
- 6 FACE SEAL: SILICONE RUBBER
- 7 COUPLING NUT: SEE TABLE
- 8 PLUG CONTACT: BERYLLIUM COPPER ALLOY, GOLD PLATED
- 9 RETENTION SLEEVE: STAINLESS STEEL, PASSIVATED

ELECTRICAL DATA:

- 1 IMPEDANCE: 50 OHMS
- 2 FREQUENCY RANGE: DC~18 GHZ

ENVIRONMENTAL DATA:

- 1 TEMPERATURE RANGE: -55°C~+125°C
- 2 2011/65/EU(RoHS) AND 2015/863/(RoHS): COMPLIANT
- 3 1999/45/EC(REACH): COMPLIANT

| REVISIONS |                        |          |          |
|-----------|------------------------|----------|----------|
| REV.      | DESCRIPTION            | DATE     | APPROVED |
| A         | INITIAL RELEASE        | 03/31/11 | J. QU    |
| B         | DRAWING FORMAT CHANGED | 10/22/18 | J. QU    |

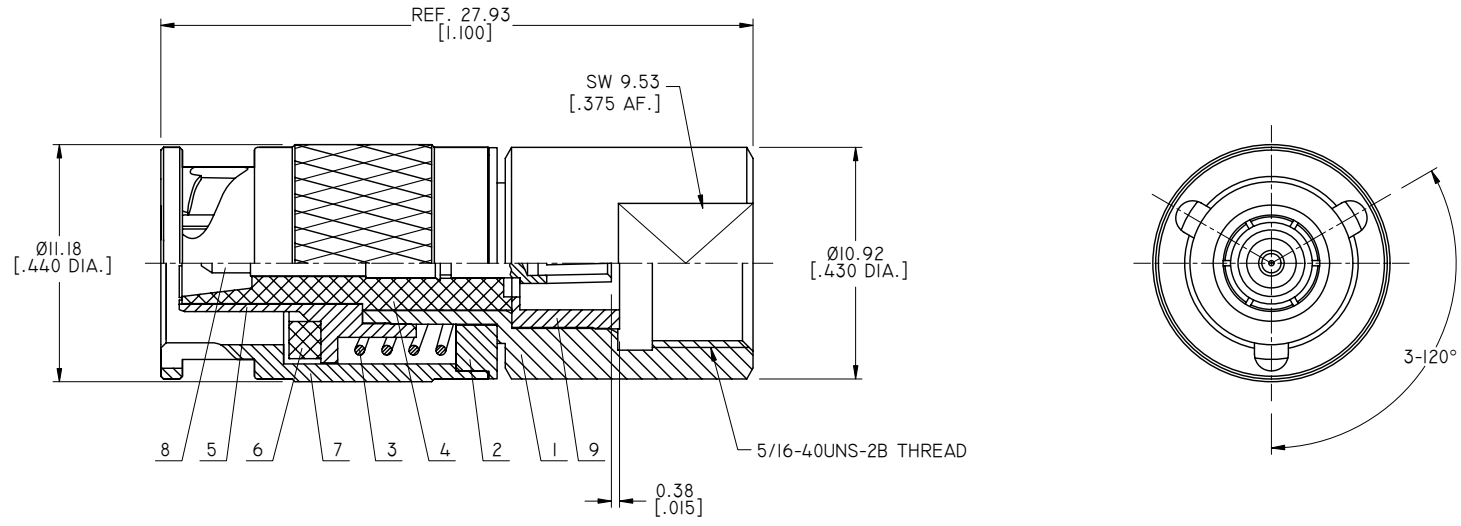

| PART NO.        | PART                                | MATERIAL        | FINISH     |
|-----------------|-------------------------------------|-----------------|------------|
| ANO 3511-2002-1 | REAR BODY/ PRESS RING/ COUPLING NUT | BRASS           | NICKEL     |
| ANO 3511-2002-2 |                                     | STAINLESS STEEL | PASSIVATED |

|   |               |  |          |
|---|---------------|--|----------|
| DRAWN   | X. B. YANG    | DATE   | 10/22/18 |
| CHECKED   | W. YANG       | DATE   | 10/22/18 |
| APPROVED  | J. QU         | DATE   | 10/22/18 |
| UNLESS OTHERWISE SPECIFIED DIMENSIONS ARE IN MILLIMETERS. DIMENSIONS IN [ ] ARE IN INCHES FOR CUSTOMER REFERENCE ONLY UNLESS OTHERWISE SPECIFIED TOLERANCE ARE: |               | THESE DRAWINGS AND SPECIFICATIONS ARE THE PROPERTY OF ANOISON ELECTRONICS LTD AND SHOULD NOT BE USED WITHOUT WRITTEN PERMISSION COPYRIGHT © 2018 ANOISON ELECTRONICS LTD |          |
| .XX   | ±0.13 [.005"] |  |          |
| .X  | ±0.20 [.008"] |  |          |
| X   | ±0.50 [.019"] |  |          |
| .X°   | ±1°           |  |          |
| X°  | ±2°           |  |          |

**TITLE**  
ZMA MALE(120°), 3 SLOT, GT520 CABLE

**VIEW**

|                                  |                     |                     |                  |
|----------------------------------|---------------------|---------------------|------------------|
| <b>PART NO.</b><br>ANO 3511-2002 |                     |                     |                  |
| <b>SIZE</b><br>A3                | <b>SCALE</b><br>4:1 | <b>SHEET</b><br>1/1 | <b>REV.</b><br>B |

4

3

2

1