

REVISIONS			
REV.	DESCRIPTION	DATE	APPROVED
A	INITIAL RELEASE	02/09/10	J. QU
B	DRAWING FORMAT CHANGED	08/17/17	J. QU

MATERIAL & FINISH:

1. BODY: STAINLESS STEEL, PASSIVATED
2. CENTER CONTACT: BERYLLIUM COPPER ALLOY, GOLD PLATED
3. INSULATOR: PTFE

ENVIRONMENTAL DATA:

1. TEMPERATURE RANGE: -55°C~+125°C
2. 2011/65/EU (RoHS): COMPLIANT

ELECTRICAL SPECIFICATIONS:

1. IMPEDANCE: 50 Ω
2. FREQUENCY RANGE: DC~40GHZ
3. VSWR: 1.15 MAX
4. DIELECTRIC WITHSTANDING VOLTAGE: 750V

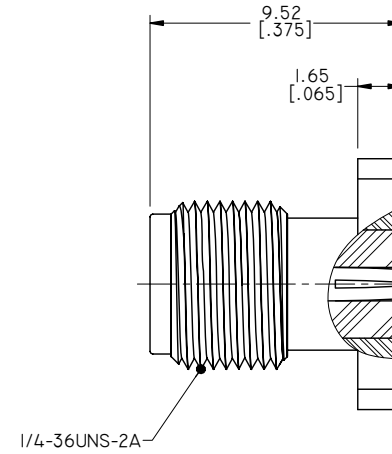
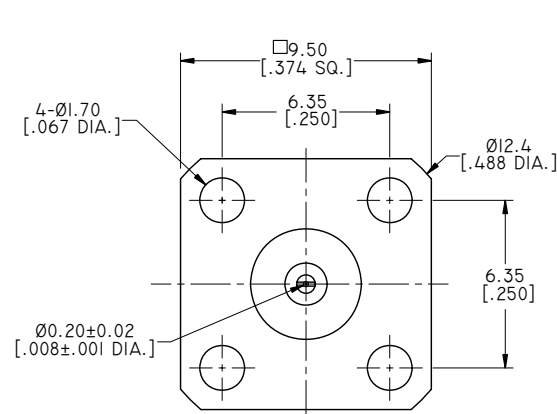

DRAWN	P. CHAN	DATE	08/17/17	
CHECKED	X. B. YANG	DATE	08/17/17	
APPROVED	J. QU	DATE	08/17/17	
UNLESS OTHERWISE SPECIFIED DIMENSIONS ARE IN MILLINMETERS, DIMENSIONS IN [] ARE IN INCHES FOR CUSTOMER REFERENCE ONLY UNLESS OTHERWISE SPECIFIED TOLERANCE ARE:		THESE DRAWINGS AND SPECIFICATIONS ARE THE PROPERTY OF ANOISON ELECTRONICS LTD AND SHOULD NOT BE USED WITHOUT WRITTEN PERMISSION COPYRIGHT © 2017 ANOISON ELECTRONICS LTD		TITLE
.XX ±0.13 [.005"] .X ±0.20 [.008"] X ±0.50 [.019"] .X° ±1° X° ±2°				2.92MM STRAIGHT FEMALE, 4 HOLES FLANGE LAUNCHERS
		VIEW		PART NO.
		SIZE	A3	ANO 2912-3014
		SCALE	5:1	SHEET
			I/1	REV.
				B