

4 3 2 1

REVISIONS			
REV.	DESCRIPTION	DATE	APPROVED
A	INTAIL RELEASE	02/05/21	J. QU

1.0 MATERIAL & FINISH:
 1.1 BODY: STAINLESS STEEL, PASSIVATED
 1.2 CENTER CONTACT: BERYLLIUM COPPER ALLOY, GOLD PLATED
 1.3 SOLDER FERRULE: BRASS, GOLD PLATED
 1.4 COUPLING NUT: STAINLESS STEEL, PASSIVATED
 1.5 INSULATOR: PEI

2.0 ELECTRICAL DATA:
 2.1 IMPEDANCE: 50 Ω
 2.2 FREQUENCY RANGE: DC~40GHZ

3.0 ENVIRONMENTAL DATA:
 3.1 TEMPERATURE RANGE: -55°C~+125°C
 3.2 2011/65/EU (RoHS): COMPLIANT

3.0 MECHANICAL DATA:
 3.1 MECHANICAL DURABILITY: 500 CYCLES MIN.
 3.2 CENTER CONTACT: CAPTIVATED
 3.3 OUTER CONTACT: SOLDERED

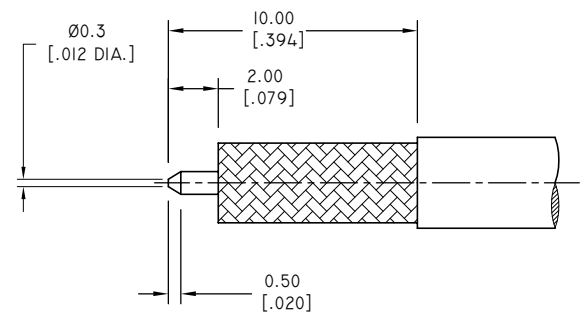
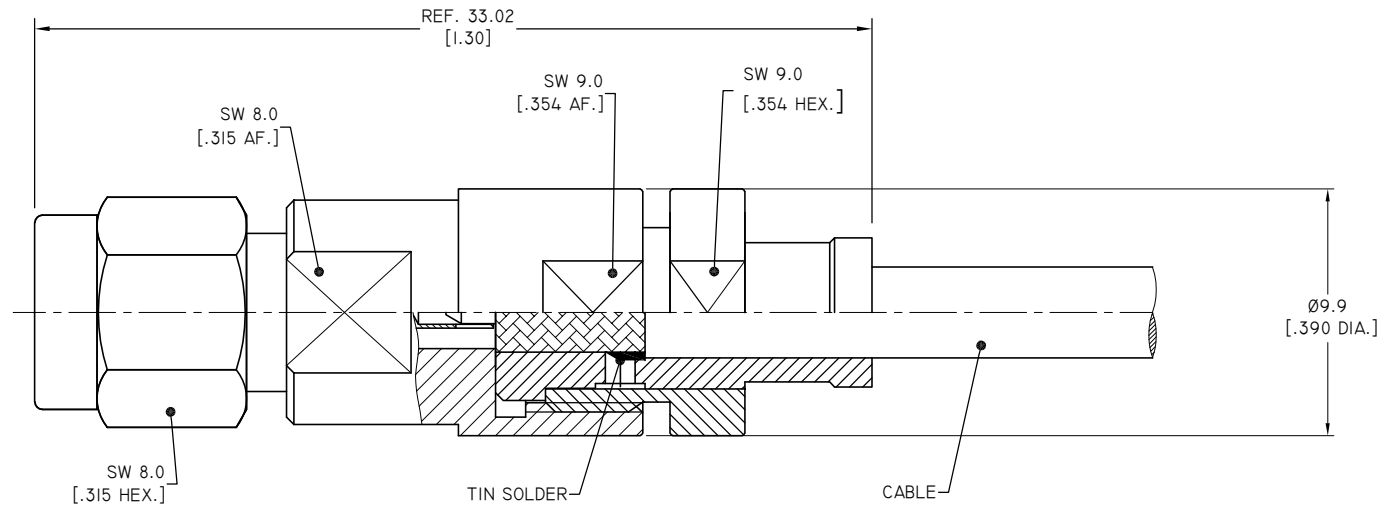

CABLE STRIPPING DIMENSIONS

DRAWN	W. YANG	DATE	02/05/21
CHECKED	L. YANG	DATE	02/05/21
APPROVED	J. QU	DATE	02/05/21
UNLESS OTHERWISE SPECIFIED DIMENSIONS ARE IN MILLIMETERS, DIMENSIONS IN [] ARE IN INCHES FOR CUSTOMER REFERENCE ONLY UNLESS OTHERWISE SPECIFIED TOLERANCE ARE:		THESE DRAWINGS AND SPECIFICATIONS ARE THE PROPERTY OF ANOISON ELECTRONICS LTD AND SHOULD NOT BE USED WITHOUT WRITTEN PERMISSION COPYRIGHT © 2021 ANOISON ELECTRONICS LTD	
.XX	±0.13 [.005"]		
.X	±0.20 [.008"]		
X	±0.50 [.019"]		
X°	±1°		
X°	±2°		



TITLE
 2.92MM STRAIGHT MALE SOLDER FOR PLEX-I40 CABLE CAPTIVATED CONTACT

VIEW	PART NO.	ANO 2911-2091		
SIZE	SCALE	SHEET	REV.	
A3	5:1	1/1	A	

4 3 2 1