

MATERIAL & FINISH

- 1 BODY: BRASS, GOLD PLATED
- 2 CENTER CONTACT: BERYLLIUM COPPER ALLOY, GOLD PLATED
- 3 INSULATOR: PTFE
- 4 COUPLING NUT: BRASS, GOLD PLATED
- 5 GASKET: SILICONE RUBBER

ELECTRICAL DATA:

- 1 IMPEDANCE: 50 OHMS
- 2 FREQUENCY RANGE: DC~12.4 GHZ

ENVIRONMENTAL DATA:

- 1 TEMPERATURE RANGE: -65°C~+165°C
- 2 2011/65/EU (RoHS): COMPLIANT

REVISIONS			
REV.	DESCRIPTION	DATE	APPROVED
A	INITIAL RELEASE	11/03/15	J. QU
B	FREQUENCY RANGE CHANGED	11/04/15	J. QU
C	1 CENTER CONTACT MATERIAL CHANGED TO BERYLLIUM COPPER ALLOY 2 TEMPERATURE RANGE CHANGED TO -65°C~+165°C	11/13/15	J. QU

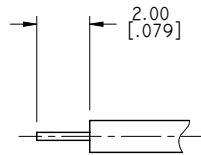
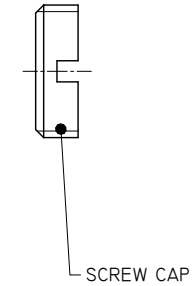
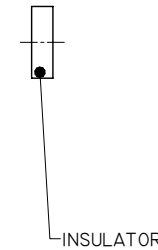
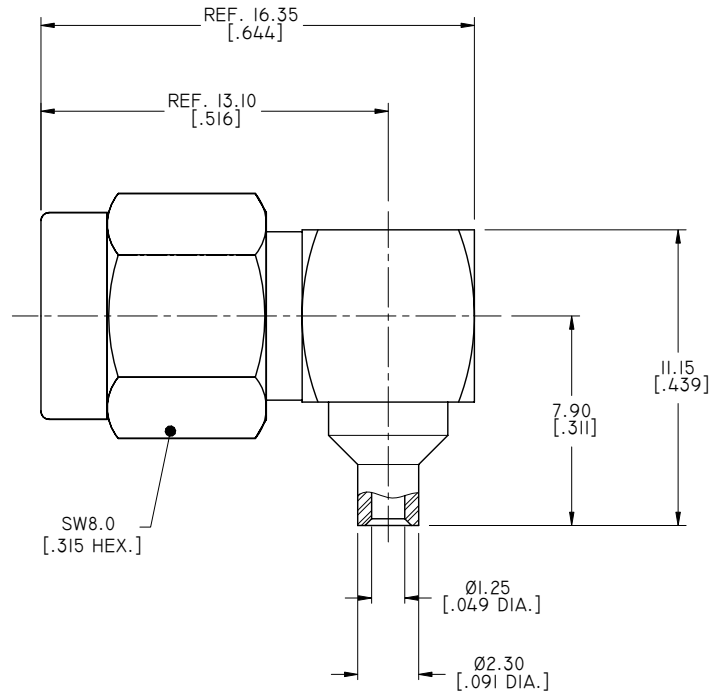

CABLE STRIPPING DIMENSIONS

DRAWN	X. B. YANG	DATE	11/13/15
CHECKED	L. YANG	DATE	11/13/15
APPROVED	J. QU	DATE	11/13/15
UNLESS OTHERWISE SPECIFIED DIMENSIONS ARE IN MILLIMETERS. DIMENSIONS IN [] ARE IN INCHES FOR CUSTOMER REFERENCE ONLY UNLESS OTHERWISE SPECIFIED TOLERANCE ARE:		THESE DRAWINGS AND SPECIFICATIONS ARE THE PROPERTY OF ANOISON ELECTRONICS LTD AND SHOULD NOT BE USED WITHOUT WRITTEN PERMISSION COPYRIGHT © 2015 ANOISON ELECTRONICS LTD	
.XX	±0.13 [.005"]		
.X	±0.20 [.008"]		
X	±0.50 [.019"]		
.X°	±1°		
X°	±2°		



TITLE
SMA RIGHT ANGLE MALE SOLDER FOR .047 CABLE

VIEW	PART NO. ANO 2121-2361		
SIZE A3	SCALE 5:1	SHEET 1/1	REV. C