

MATERIAL & FINISH:

1. BODY: BRASS, NICKEL PLATED
2. CENTER CONTACT: BRASS, GOLD PLATED
3. INSULATOR: PTFE
4. COUPLING NUT: BRASS, NICKEL PLATED

ENVIRONMENTAL DATA:

1. TEMPERATURE RANGE: -55°C~+125°C
2. 2011/65/EU (RoHS): COMPLIANT

ELECTRICAL SPECIFICATIONS:

1. IMPEDANCE: 50 Ω
2. FREQUENCY RANGE: DC~6GHZ
3. VSWR: 1.25 MAX

REVISIONS			
REV.	DESCRIPTION	DATE	APPROVED
A	INITIAL RELEASE	05/23/15	J. QU

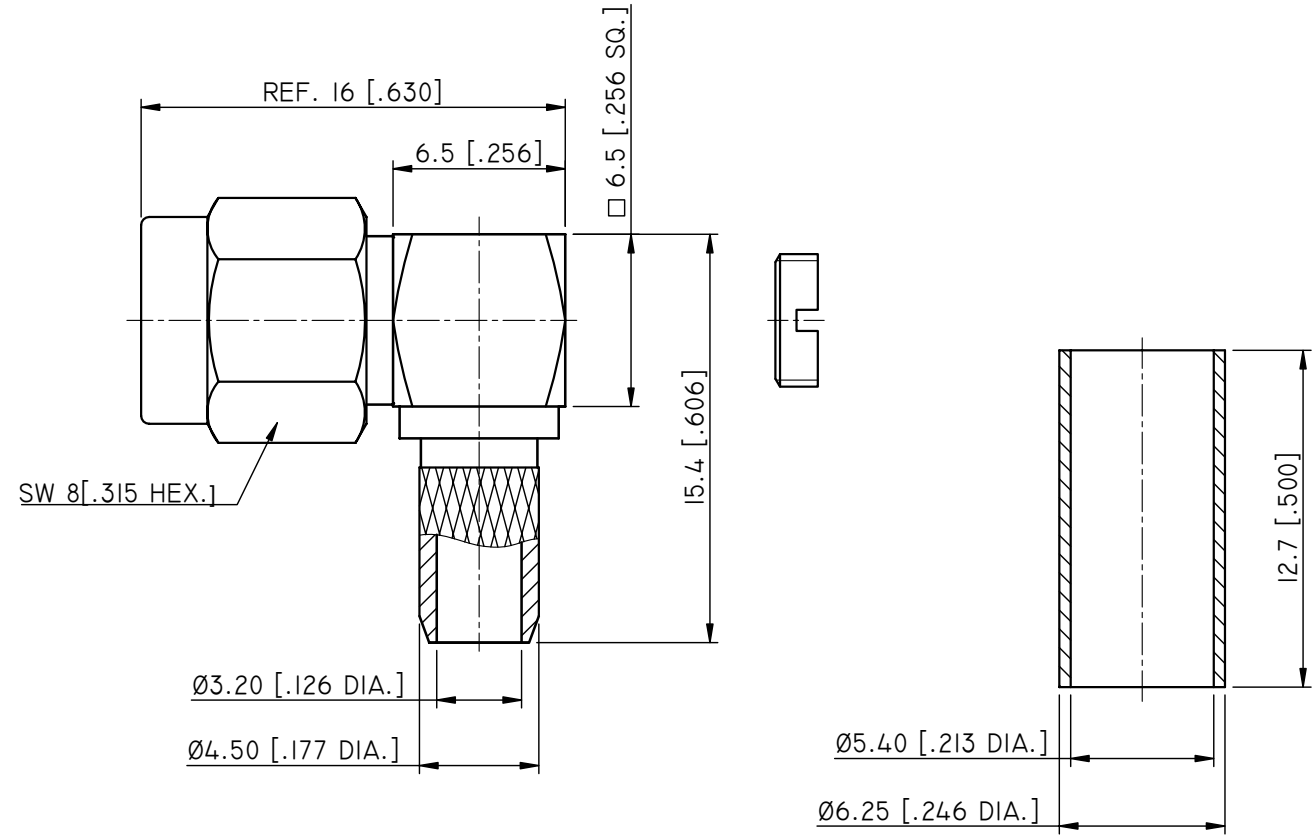

SW 8 [.315 HEX.]

Ø3.20 [.126 DIA.]

Ø4.50 [.177 DIA.]

Ø5.40 [.213 DIA.]

Ø6.25 [.246 DIA.]

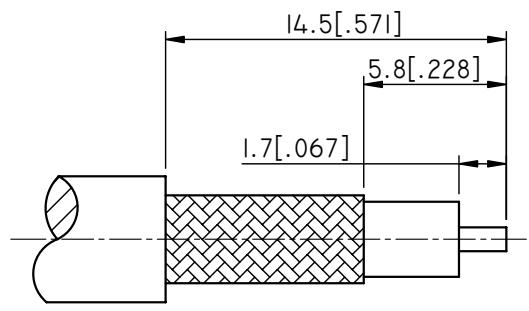

CABLE STRIPPING DIMENSIONS

HEX. CRIMP TOOL

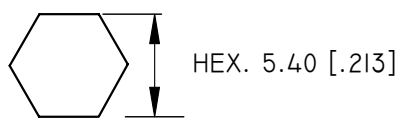

HEX. 5.40 [.213]
CRIMP WIDTH: 10 [.394]

DRAWN	L. YANG	DATE	05/23/15
CHECKED	X. B. YANG	DATE	05/23/15
APPROVED	J. QU	DATE	05/23/15
UNLESS OTHERWISE SPECIFIED DIMENSIONS ARE IN MILLIMETERS, DIMENSIONS IN [] ARE IN INCHES FOR CUSTOMER REFERENCE ONLY UNLESS OTHERWISE SPECIFIED TOLERANCE ARE:		THESE DRAWINGS AND SPECIFICATIONS ARE THE PROPERTY OF ANOISON ELECTRONICS LTD AND SHOULD NOT BE USED WITHOUT WRITTEN PERMISSION COPYRIGHT © 2015 ANOISON ELECTRONICS LTD	
.XX	±0.13 [.005"]		
.X	±0.20 [.008"]		
X	±0.50 [.019"]		
.X°	±1°		
X°	±2°		



TITLE			
SMA RIGHT ANGLE MALE CRIMP FOR LMR200 CABLE			
VIEW	PART NO.	ANO 2121-2348	
SIZE	SCALE	SHEET	REV.
A3	5:1	1/1	A