

**MATERIAL & FINISH:**

- 1 BODY: BRASS, GOLD PLATED
- 2 CENTER CONTACT: BERYLLIUM COPPER ALLOY, GOLD PLATED
- 3 INSULATOR: PTFE

**MECHANICAL DATA:**

- 1 ENGAGE/DISENGAGE TORQUE: 2 INCH-POUNDS MAX.
- 2 MATING TORQUE: 7-10 INCH POUNDS WHEN BODY SUPPORTED WITH WRENCH
- 3 CONTACT RETENTION: 6 LBS MIN. AXIAL FORCE ON MATING END  
4 IN-OZ MIN RADIAL TORQUE
- 4 DURABILITY: 500 CYCLES MIN.

**ELECTRICAL DATA:**

- 1 IMPEDANCE: 50 OHMS
- 2 FREQUENCY RANGE: DC~26.5 GHZ
- 3 VSWR: 1.05+.02F(GHZ) MAX. DC~18 GHZ, TYPICALLY <1.5 AT 18~26.5GHZ
- 4 CONTACT RESISTANCE:  
CENTER CONTACT - INITIAL 3.0 MILLIOHM MAX. AFTER ENVIRONMENTAL 4.0 MILLIOHM MAX.  
OUTER CONDUCTOR - INITIAL 2.0 MILLIOHM MAX.

**ENVIRONMENTAL DATA:**

- MEETS OR EXCEEDS THE APPLICABLE PARAGRAPH OF MIL-PRF-39012
- 1 OPERATING TEMPERATURE: -65°C~+165°C
- 2 2015/863/(RoHS): COMPLIANT
- 3 1907/2006/EC(REACH) AND 1999/45/EC(REACH): COMPLIANT

REVISIONS			
REV.	DESCRIPTION	DATE	APPROVED
A	INITIAL RELEASE	05/20/19	J. QU

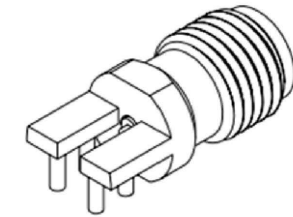
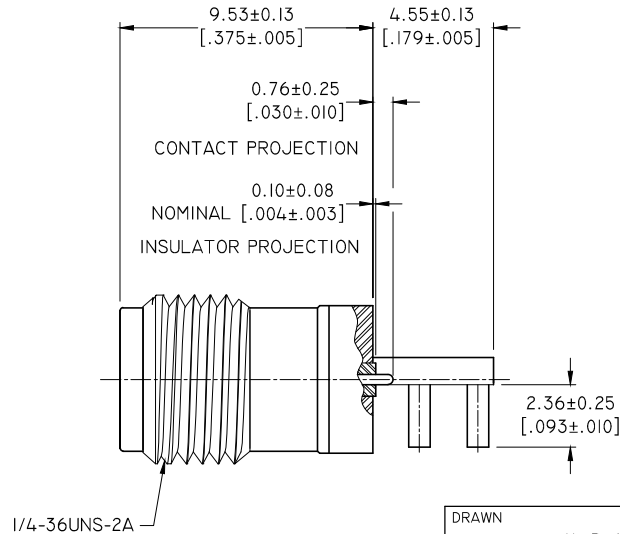
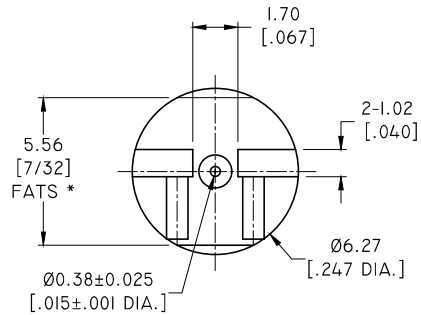
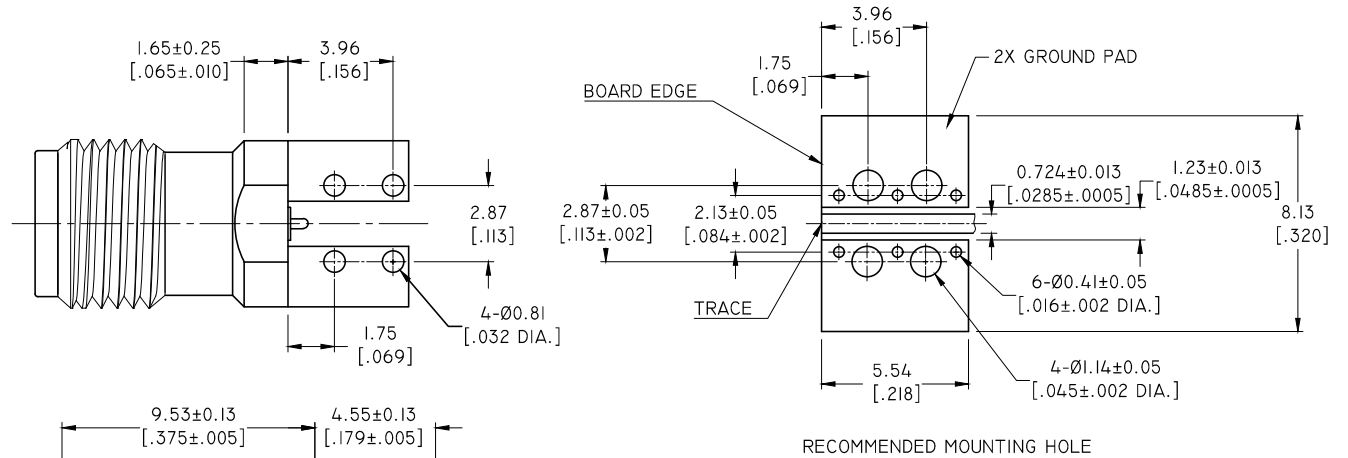

DRAWN	X. B. YANG	DATE	05/20/19
CHECKED	LW. YANG	DATE	05/20/19
APPROVED	J. QU	DATE	05/20/19
UNLESS OTHERWISE SPECIFIED DIMENSIONS ARE IN MILLINETERS. DIMENSIONS IN [ ] ARE IN INCHES FOR CUSTOMER REFERENCE ONLY UNLESS OTHERWISE SPECIFIED TOLERANCE ARE:		THESE DRAWINGS AND SPECIFICATIONS ARE THE PROPERTY OF ANOISON ELECTRONICS LTD AND SHOULD NOT BE USED WITHOUT WRITTEN PERMISSION COPYRIGHT © 2019 ANOISON ELECTRONICS LTD	
.XX	+0.08 [.003"]		
.X	+0.20 [.008"]		
X	+0.50 [.019"]		
.X°	±1°		
X°	±2°		



TITLE				
SMA FEMALE, HIGH FREQ END LAUNCH PCB MOUNT, 15 MIL PIN				
VIEW		PART NO.		
		ANO 2112-4528		
SIZE	SCALE	SHEET	REV.	
A3	5:1	1/1	A	