

MATERIAL & FINISH:

1. BODY: BRASS, GOLD PLATED
2. CENTER CONTACT: BERYLLIUM COPPER ALLOY, GOLD PLATED
3. INSULATOR: PTFE

ENVIRONMENTAL DATA:

1. TEMPERATURE RANGE: -55 °C~+125 °C
2. 2002/95/EC (RoHS): COMPLIANT

ELECTRICAL DATA:

1. IMPEDANCE: 50 Ω
2. FREQUENCY RANGE: DC~18 GHZ

| REVISIONS | | | |
|-----------|-----------------|----------|----------|
| REV. | DESCRIPTION | DATE | APPROVED |
| A | INITIAL RELEASE | 04/29/14 | J. QU |
| | | | |

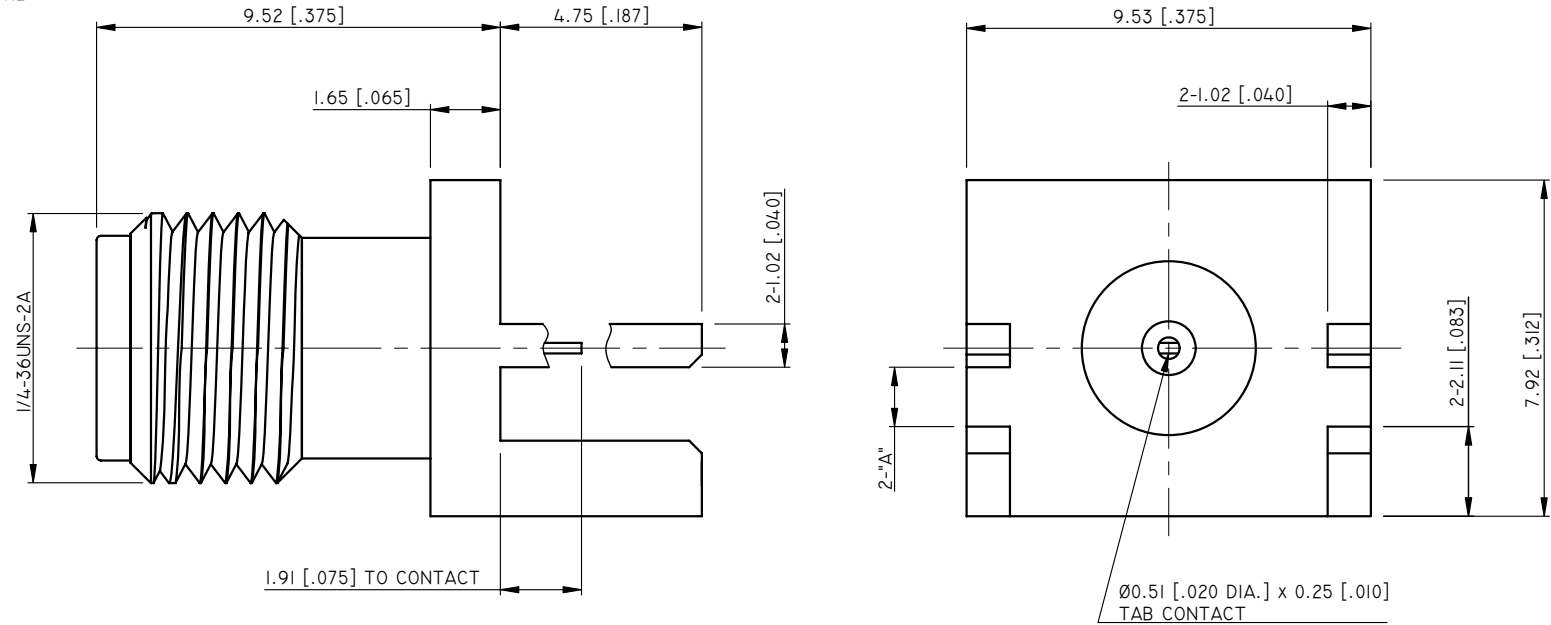

| PART NUMBER | BOARD THICKNESS | "A" |
|---------------|-----------------|-------------|
| ANO 2112-4303 | 1.07 [.042] | 1.19 [.047] |
| ANO 2112-4304 | 1.57 [.062] | 1.73 [.068] |

| | | | |
|--|------------------|---|---------------------|
| DRAWN X. B. YANG | DATE 04/29/14 | | |
| CHECKED L. YANG | DATE 04/29/14 | | |
| APPROVED J. QU | DATE 04/29/14 | | |
| <small>UNLESS OTHERWISE SPECIFIED DIMENSIONS ARE IN MILLIMETERS, DIMENSIONS IN [] ARE IN INCHES FOR CUSTOMER REFERENCE ONLY UNLESS OTHERWISE SPECIFIED TOLERANCE ARE:</small> | | <small>THESE DRAWINGS AND SPECIFICATIONS ARE THE PROPERTY OF ANOISON ELECTRONICS LTD AND SHOULD NOT BE USED WITHOUT WRITTEN PERMISSION COPYRIGHT © 2013 ANOISON</small> | |
| <small>.XX ±0.13 [.005"] .X ±0.20 [.008"] X ±0.50 [.019"] .X° ±1° X° ±2°</small> | | TITLE SMA END LAUNCH JACK RECEPTACLE-TAB CONTACT | |
| VIEW | | PART NO. ANO 2112-XXXX | |
| SIZE A3 | | SCALE 8:1 | SHEET 1/1 |
| | | REV. A | |