

4

3

2

1

**MATERIAL & FINISH:**

- 1 BODY: SEE TABLE
- 2 CENTER CONTACT: SEE TABLE
- 3 INSULATOR: PTFE
- 4 EPOXY: BISPHENOL A EPOXY RESINS

**ENVIRONMENTAL DATA:**

- 1 TEMPERATURE RANGE: -65°C~+125°C
- 2 THERMAL SHOCK: MIL-STD-202, METHOD 107, TEST COND. A. MOISTURE RESISTANCE: MIL-STD-202, METHOD 106. INSULATION 5 MINUTES AFTER REMOVAL FROM HUMIDITY. CORROSION: MIL-STD-202, METHOD 101, TEST COND. B. VIBRATION: MIL-STD-202, METHOD 204, TEST COND. D. SHOCK: MIL-STD-202, METHOD 213, TEST COND. I
- 3 2011/65/EU ( RoHS) AND 2015/863/(RoHS): COMPLIANT
- 4 1999/45/EC(REACH): COMPLIANT

**MECHANICAL DATA:**

- 1 FORCE TO ENGAGE: TORQUE: 2 INCH-POUNDS MAX.
- 2 CONNECTOR DURABILITY: 500 CYCLES MIN. AT 12 CYCLES/MINUTE MAX.
- 3 CENTER CONTACT CAPTIVATION: AXIAL FORCE FROM INTERFACE: 6 POUNDS MIN. RADIAL TORQUE: 4 INCH-OUNCES MIN.

**ELECTRICAL DATA:**

- 1 IMPEDANCE: 50 Ω
- 2 FREQUENCY RANGE: DC-18 GHz
- 3 VSWR: 1.05+.005F(GHZ)
- 4 INSERTION LOSS: 0.03 √F (GHZ) DB MAX.
- 5 DIELECTRIC WITHSTANDING VOLTAGE: 1000V
- 6 INSULATION RESISTANCE: 5000 MΩ
- 7 WORKING VOLTAGE: 335 VRMS MAX. AT SEA LEVEL
- 8 CONTACT RESISTANCE: CENTER CONDUCTOR: BEFORE ENVIRONMENTAL: 3.0 MILLIOHMS AFTER ENVIRONMENTAL: 4.0 MILLIOHMS OUTER CONDUCTOR: BEFORE ENVIRONMENTAL: 2.0 MILLIOHMS

REVISIONS			
REV.	DESCRIPTION	DATE	APPROVED
D	1. PART NO. ANO 2112-3070-3 ADDED 2. VSWR ADDED	08/08/18	J. Q
E	CHANGED VSWR	08/22/18	J. Q
F	CHANGED ELECTRICAL DATA ADDED MECHANICAL DATA	09/06/18	J. Q
G	CHANGED TEMPERATURE RANGE	08/28/19	J. Q
H	ADDED PLATING THICKNESS	08/08/25	J. Q

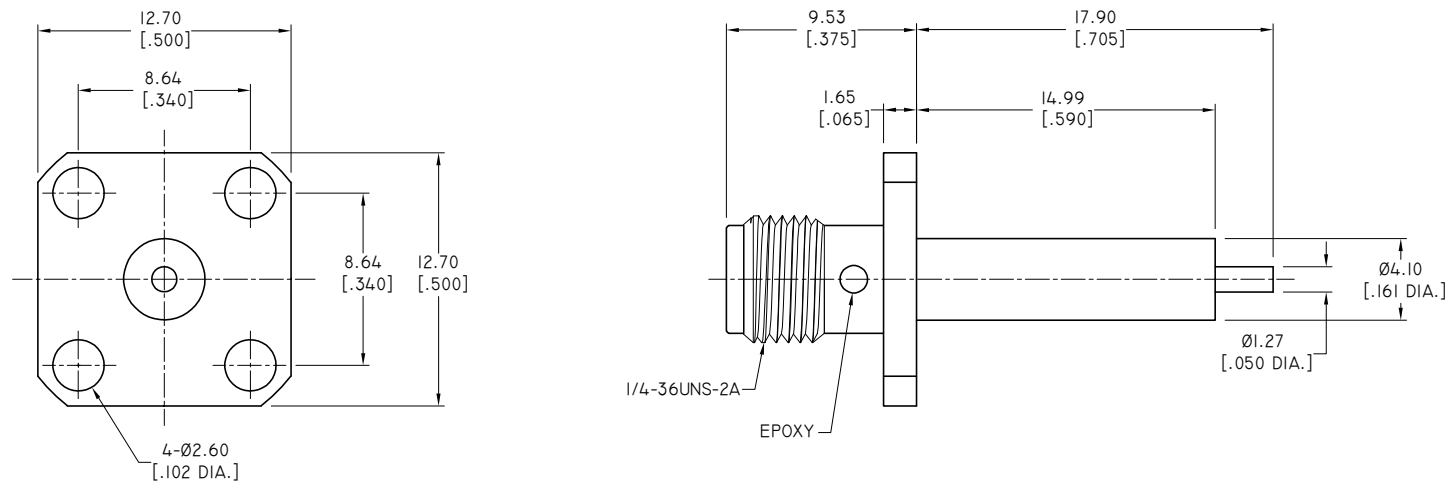

TABLE

PART NUMBER	PART	MATERIAL	FINISH
ANO 2112-3070	BODY	STAINLESS STEEL	PASSIVATED
	CENTER CONTACT	BERYLLIUM COPPER ALLOY	GOLD 0.1µm(0.05~0.15µm) OVER NICKEL 2 µm(2~4µm)
ANO 2112-3070-1	BODY	BRASS	GOLD 0.1µm(0.05~0.15µm) OVER NICKEL 2 µm(2~4µm)
	CENTER CONTACT	BERYLLIUM COPPER ALLOY	GOLD 0.1µm(0.05~0.15µm) OVER NICKEL 2 µm(2~4µm)
ANO 2112-3070-2	BODY	BRASS	SnZnCu 3µm(2~3µm)
	CENTER CONTACT	BERYLLIUM COPPER ALLOY	Ag3µm(2~3µm)
ANO 2112-3070-3	BODY	STAINLESS STEEL	GOLD 0.25µm(0.2~0.30µm) OVER NICKEL 2 µm(2~4µm)
	CENTER CONTACT	BERYLLIUM COPPER ALLOY	GOLD 0.25µm(0.2~0.30µm) OVER NICKEL 2 µm(2~4µm)

DRAWN	W. Y	DATE	08/08/25
CHECKED	X. Y	DATE	08/08/25
APPROVED	J. Q	DATE	08/08/25
UNLESS OTHERWISE SPECIFIED DIMENSIONS ARE IN MILLIMETERS, DIMENSIONS IN [ ] ARE IN INCHES FOR CUSTOMER REFERENCE ONLY UNLESS OTHERWISE SPECIFIED TOLERANCE ARE:		THESE DRAWINGS AND SPECIFICATIONS ARE THE PROPERTY OF ANOISON ELECTRONICS LTD AND SHOULD NOT BE USED WITHOUT WRITTEN PERMISSION COPYRIGHT © 2025 ANOISON ELECTRONICS LTD	
.XX	±0.13 [ .005"		
.X	±0.20 [ .008"		
X	±0.50 [ .019"		
.X°	±1°		
X°	±2°		



TITLE  
SMA STRAIGHT FEMALE, 4 HOLE .500 SQ. FLANGE MOUNT

VIEW	PART NO. ANO 2112-3070			
	SIZE A3	SCALE 4:1	SHEET 1/1	REV. H

4

3

2

1