

MATERIAL & FINISH:

1. BODY: STAINLESS STEEL, PASSIVATED
2. CENTER CONTACT: BERYLLIUM COPPER ALLOY, GOLD PLATED
3. COUPLING NUT: STAINLESS STEEL, PASSIVATED
4. RETAINING RING: BERYLLIUM COPPER ALLOY, NICKEL PLATED
5. INSULATOR: PEI & PTFE

ELECTRICAL SPECIFICATIONS:

1. IMPEDANCE: 50 Ω
2. FREQUENCY RANGE: DC~26.5GHZ
3. VSWR: 1.05+.006*F(GHZ)
4. INSERTION LOSS (DB MAX.): .04*√F(GHZ)
5. DIELECTRIC WITHSTANDING VOLTAGE: 750V

ENVIRONMENTAL DATA:

1. TEMPERATURE RANGE: -65°C~+165°C
2. 2011/65/EU (RoHS): COMPLIANT

REVISIONS			
REV.	DESCRIPTION	DATE	APPROVED
A	INITIAL RELEASE	04/21/17	J. QU
B	.102" WAS .081" , .492" WAS .470" .346" WAS .335"	05/05/17	J. QU

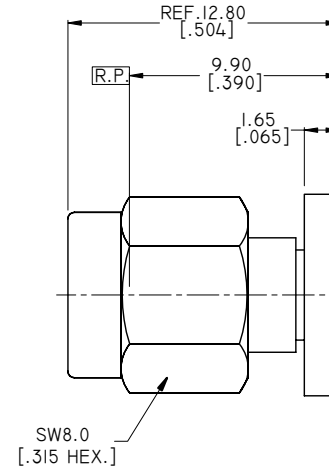
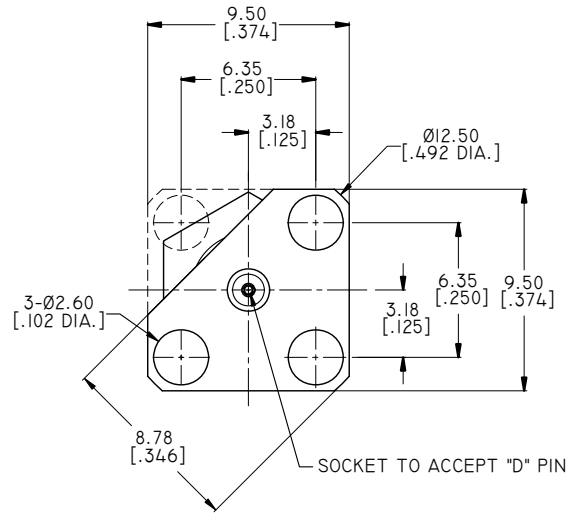

PART NO.	D	PIN DEPTH MAX.
ANO 2111-3447-1	Ø0.30 [.012 DIA.]	1.90 [.075]
ANO 2111-3447-2	Ø0.38 [.015 DIA.]	2.54 [.100]

DRAWN	P. CHEN	DATE	05/05/17
CHECKED	L. YANG	DATE	05/05/17
APPROVED	J. QU	DATE	05/05/17
UNLESS OTHERWISE SPECIFIED DIMENSIONS ARE IN MILLIMETERS. DIMENSIONS IN [] ARE IN INCHES FOR CUSTOMER REFERENCE ONLY UNLESS OTHERWISE SPECIFIED TOLERANCE ARE:		THESE DRAWINGS AND SPECIFICATIONS ARE THE PROPERTY OF ANOISON ELECTRONICS LTD AND SHOULD NOT BE USED WITHOUT WRITTEN PERMISSION COPYRIGHT © 2017 ANOISON ELECTRONICS LTD	
.XX	±0.08 [.003"]		
.X	±0.20 [.008"]		
X	±0.50 [.019"]		
.X°	±1°		
X°	±2°		



TITLE
SMA STRAIGHT MALE, 4 HOLES FLANGE
FIELD REPLACEABLE

VIEW	PART NO. ANO 2111-3447		
	SIZE A3	SCALE 4:1	SHEET 1/1
		REV. B	