

MATERIAL & FINISH:

- 1 BODY: SEE TABLE
- 2 CENTER CONTACT: SEE TABLE
- 3 INSULATOR: PTFE
- 4 COUPLING NUT: SEE TABLE
- 5 GASKET: SILICONE RUBBER

ELECTRICAL DATA:

- 1 IMPEDANCE: 50 Ω
- 2 FREQUENCY RANGE: DC-26.5 GHz
- 3 VSWR: 1.15 MAX. AT DC-12 GHz
1.20 MAX. AT 12-18 GHz
1.30 MAX. AT 18-26.5 GHz

ENVIRONMENTAL DATA:

- 1 TEMPERATURE RANGE: -55°C~+125°C
- 2 2011/65/EU(RoHS) AND 2015/863/(RoHS): COMPLIANT
- 3 1907/2006/EC(REACH): COMPLIANT

REVISIONS			
REV.	DESCRIPTION	DATE	APPROVED
A	INITIAL RELEASE	12/07/18	J. QU
B	ADDED P/N, CHANGED ELECTRICAL DATA	11/05/19	J. QU
C	PART NO. ANO 2111-2512-2 ADDED	04/07/20	J. QU
D	OUTLINE DRAWING CHANGED	01/24/22	J. QU
E	PART NO. ANO 2111-2512-3 ADDED	06/29/22	J. QU
F	VSWR CHANGED	08/04/23	J. QU

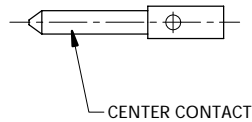
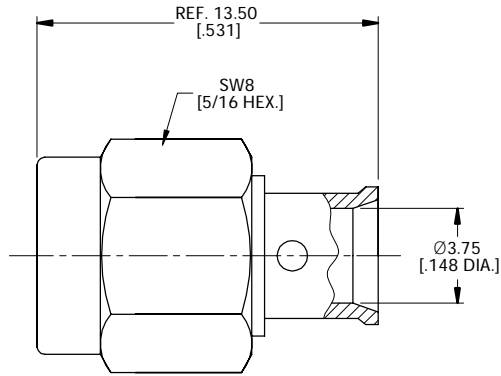

TABLE

PART NO.	PART	MATERIAL	FINISH
ANO 2111-2512	BODY	BRASS	GOLD
	CENTER CONTACT	BRASS	GOLD
	COUPLING NUT	BRASS	GOLD
ANO 2111-2512-1	BODY	BRASS	GOLD
	CENTER CONTACT	BRASS	GOLD
	COUPLING NUT	STAINLESS STEEL	PASSIVATED
ANO 2111-2512-2	BODY	BRASS	ALBALOY
	CENTER CONTACT	BRASS	SILVER
	COUPLING NUT	BRASS	ALBALOY
ANO 2111-2512-3	BODY	PHOSPHOR BRONZE	SILVER
	CENTER CONTACT	PHOSPHOR BRONZE	SILVER
	COUPLING NUT	BRASS	ALBALOY
ANO 2111-2512-4	BODY	PHOSPHOR BRONZE	SILVER
	CENTER CONTACT	PHOSPHOR BRONZE	SILVER
	COUPLING NUT	STAINLESS STEEL	PASSIVATED

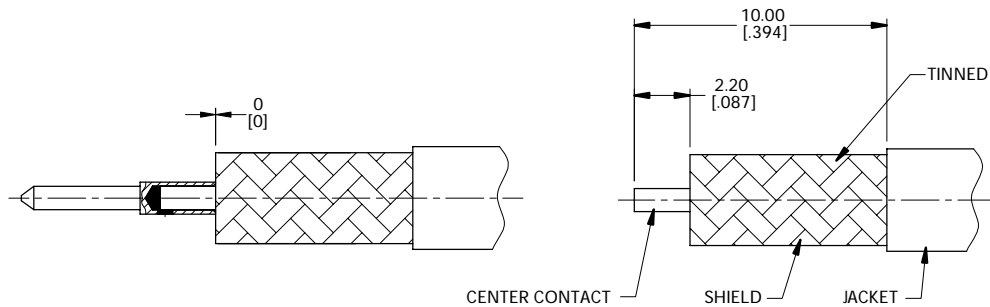

CABLE STRIPPING DIMENSIONS

DRAWN	X. Y	DATE	08/04/23
CHECKED	W. Y	DATE	08/04/23
APPROVED	J. Q	DATE	08/04/23
UNLESS OTHERWISE SPECIFIED DIMENSIONS ARE IN MILLIMETERS, DIMENSIONS IN [] ARE IN INCHES FOR CUSTOMER REFERENCE ONLY UNLESS OTHERWISE SPECIFIED TOLERANCE ARE:		THESE DRAWINGS AND SPECIFICATIONS ARE THE PROPERTY OF ANOISON ELECTRONICS LTD AND SHOULD NOT BE USED WITHOUT WRITTEN PERMISSION COPYRIGHT © 2022 ANOISON ELECTRONICS LTD	
XX	±0.13 [.005"]		
X	±0.20 [.008"]		
X	±0.50 [.019"]		
X°	±1°		
X"	±2°		



TITLE
SMA STRAIGHT MALE SOLDER FOR AFLEX141 CABLE

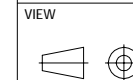

PART NO. ANO 2111-2512			
SIZE A3	SCALE 5:1	SHEET 1/1	REV. F