

4 3 2 1

REVISIONS			
REV.	DESCRIPTION	DATE	APPROVED
A	INITIAL RELEASE	09/27/20	J. Q
B	ADDED BODY MATERIAL	08/18/23	J. Q

**MATERIAL & FINISH:**

- 1 BODY: SEE TABLE, GOLD PLATED
- 2 CENTER CONTACT: BRASS, GOLD PLATED
- 3 INSULATOR: PTFE

**ELECTRICAL DATA:**

- 1 IMPEDANCE: 50 Ω
- 2 FREQUENCY RANGE: DC-22 GHZ
- 3 VSWR: 1.50 MAX.

**ENVIRONMENTAL DATA:**

- 1 TEMPERATURE RANGE: -55°C ~ +165°C
- 2 2011/65/EU(RoHS) AND 2015/863/(RoHS): COMPLIANT
- 3 1999/45/EC(REACH): COMPLIANT

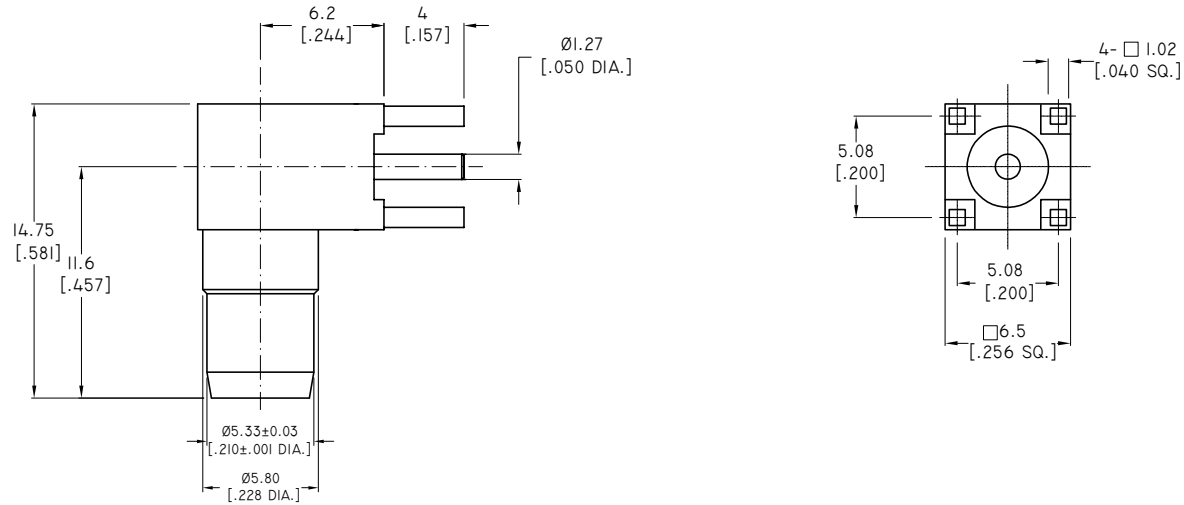

PART NO.	BODY MATERIAL
ANO 1421-4016	BRASS
ANO 1421-4016-1	STAINLESS STEEL 303

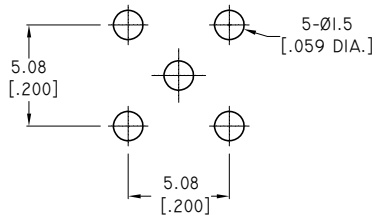

RECOMMENDED MOUNTING HOLE

DRAWN	W. Y	DATE	08/18/23
CHECKED	X. Y	DATE	08/18/23
APPROVED	J. Q	DATE	08/18/23
UNLESS OTHERWISE SPECIFIED DIMENSIONS ARE IN MILLIMETERS, DIMENSIONS IN [ ] ARE IN INCHES FOR CUSTOMER REFERENCE ONLY UNLESS OTHERWISE SPECIFIED TOLERANCE ARE:		THESE DRAWINGS AND SPECIFICATIONS ARE THE PROPERTY OF ANOISON ELECTRONICS LTD AND SHOULD NOT BE USED WITHOUT WRITTEN PERMISSION COPYRIGHT © 2023 ANOISON ELECTRONICS LTD	
.XX	±0.13 [0.005"]		
.X	±0.20 [0.008"]		
X°	±0.50 [0.019"]		
X°	±1°		
X°	±2°		



TITLE			
BMA RIGHT ANGLE PLUG PCB RECEPTACLE			
VIEW	PART NO.		
	ANO 1421-4016		
SIZE	SCALE	SHEET	REV.
A3	4:1	1/1	B

4 3 2 1