

DESCRIPTION	MATERIAL	FINISH
Center Contact	Brass	Gold
Outer Contact	Beryllium Copper Alloy	Gold
Body	Brass	Gold
Crimp Ferrule	Copper	Nickel
Insulator	PTFE	

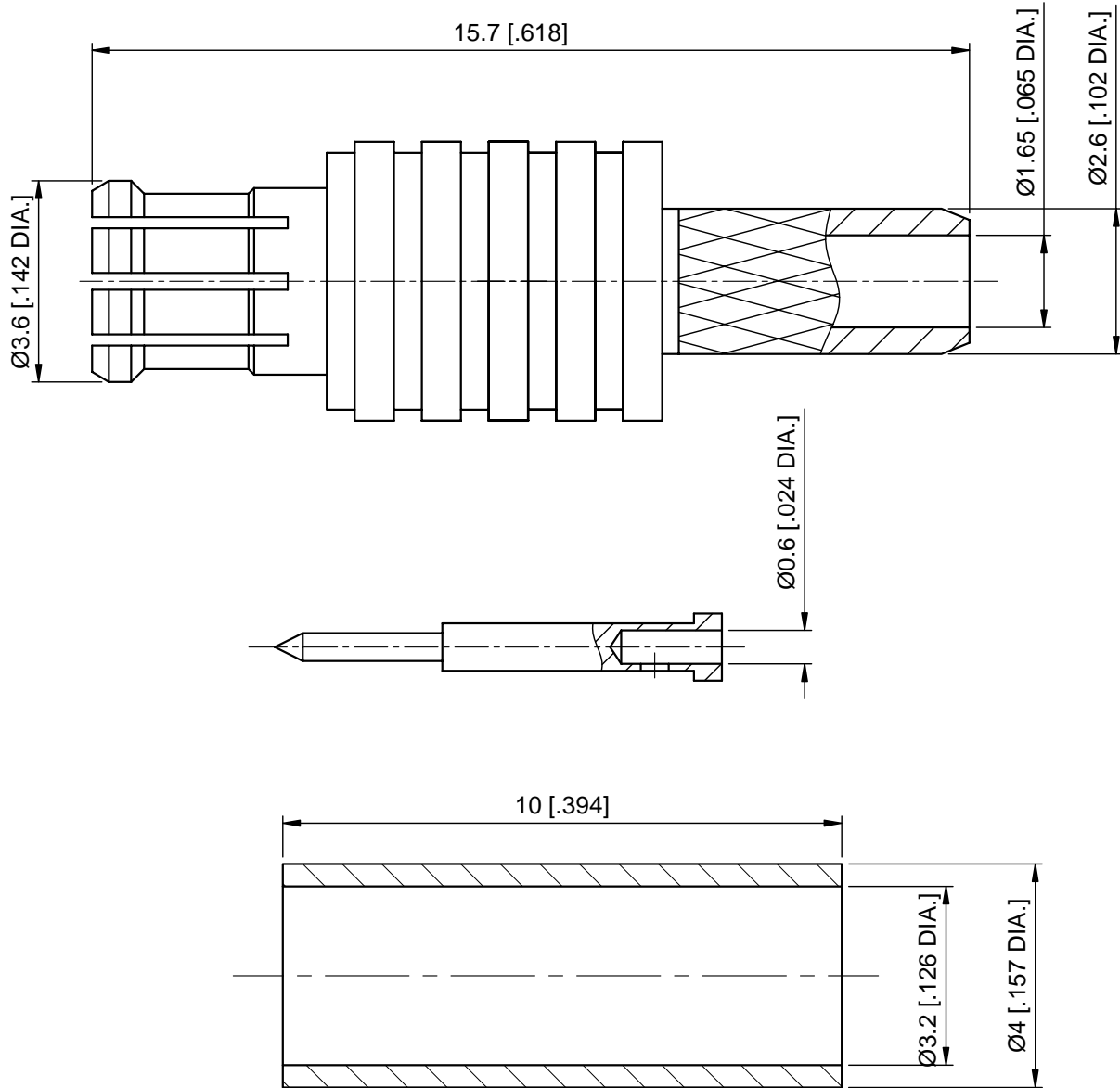

CRIMP SIZES REQUIRED
 FERRULE: 3.25 [.128]
 HEX. CRIMP TOOL

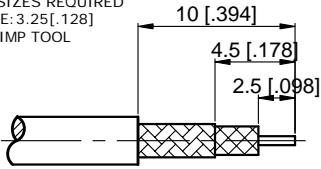

CABLE STRIPPING DIMENSIONS

NOTES:

1. ALL SPECIFICATIONS ARE SUBJECT TO CHANGE WITHOUT NOTICE AT ANY TIME
2. CUSTOMER OUTLINE DRAWING FOR REFERENCE ONLY

Drawn: L. Yang 07/10/05

Checked: B. Pan 07/10/05

Approved: J. Qu 07/10/05

Unless otherwise specified dimensions are in millimeters, dimensions in [] are in inches for customer reference only.

Unless Otherwise Specified tolerance are:

- .XX ±0.13 [.005"]
- .X ±0.20 [.008"]
- X ±0.50 [.019"]
- .X° ±1°
- X° ±2°

Title:

MCX Straight Male Crimp for LMR100/RG316/RG174 Cable



Part No:

ANO 1311-2005

View:



Size:

A4

Scale:

8:1

Sheet:

1/1

Rev:

A