

### Design Features

- Excellent performance up to 35GHz
- Low VSWR and insertion loss
- Rugged construction for reliability
- Reduced size for high density packaging

### Main Specifications

- Impedance: 50Ω
- Frequency range: DC~40GHz
- Dielectric withstanding voltage(V.R.M.S.): 750V
- Durability: ≥500

### Material/Plating

- Body: Stainless steel
- Center Conductor: Beryllium copper
- Insulators: PTFE & PEI
- Passivated
- Gold

### SSMA Jack (Female)

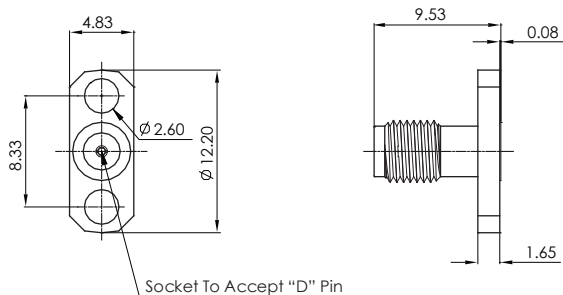

Connector No.	D	MAX. Pin Depth
<a href="#">ANO9112-3033-1</a>	0.23	1.65
<a href="#">ANO9112-3033-2</a>	0.30	1.19
<a href="#">ANO9112-3033-3</a>	0.38	2.54
<a href="#">ANO9112-3033-4</a>	0.46	2.54
<a href="#">ANO9112-3033-5</a>	0.51	2.54

### SSMA Jack (Female)

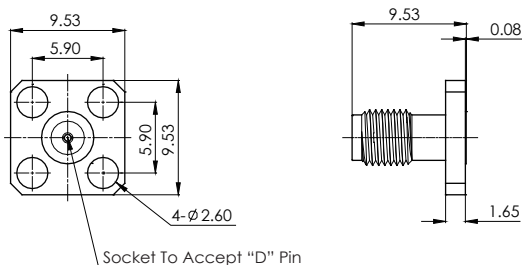

Connector No.	D	MAX. Pin Depth
<a href="#">ANO9112-3035-1</a>	0.23	1.65
<a href="#">ANO9112-3035-2</a>	0.30	1.91
<a href="#">ANO9112-3035-3</a>	0.38	2.54
<a href="#">ANO9112-3035-4</a>	0.46	2.54
<a href="#">ANO9112-3035-5</a>	0.51	2.54

### SSMA Jack (Female)

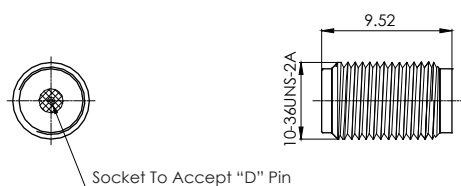

Connector No.	D	MAX. Pin Depth
<a href="#">ANO9112-3032-1</a>	0.23	1.65
<a href="#">ANO9112-3032-2</a>	0.30	1.91
<a href="#">ANO9112-3032-3</a>	0.38	2.54
<a href="#">ANO9112-3032-4</a>	0.46	2.54
<a href="#">ANO9112-3032-5</a>	0.51	2.54

### SSMA Plug (Male)

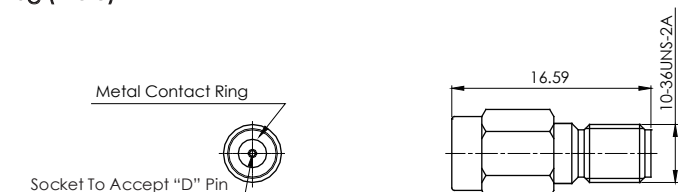

Connector No.	D	MAX. Pin Depth
<a href="#">ANO9111-3036-1</a>	0.23	1.65
<a href="#">ANO9111-3036-2</a>	0.30	1.91
<a href="#">ANO9111-3036-3</a>	0.38	2.54
<a href="#">ANO9111-3036-4</a>	0.46	2.54
<a href="#">ANO9111-3036-5</a>	0.51	2.54