

2.92mm Design Features

Excellent performance up to 40GHz

Low VSWR and insertion loss

Rugged construction for reliability Mechanically compatible with 3.5mm connector series

Main Specifications

Impedance: 50Ω

Frequency range: DC~40GHz

VSWR: ≤1.15

Dielectric withstanding voltage(V.R.M.S.): 750V

Durability: ≥500

Material/Plating

Body: Stainless steel

Passivated

Center Conductor: Beryllium copper

Gold

Insulators: PEI

2.92mm Jack (Female)

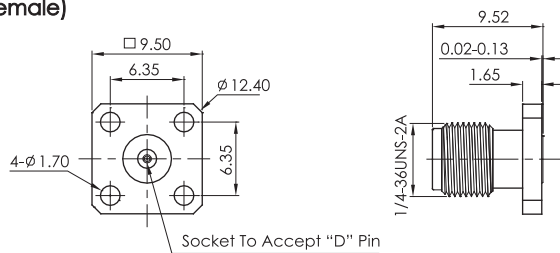

Connector No.	D	MAX. Pin Depth
ANO2912-3050-1	0.23	1.65
ANO2912-3050-2	0.30	1.65
ANO2912-3050-3	0.38	1.65
ANO2912-3050-4	0.51	1.65

2.92mm Jack (Female)

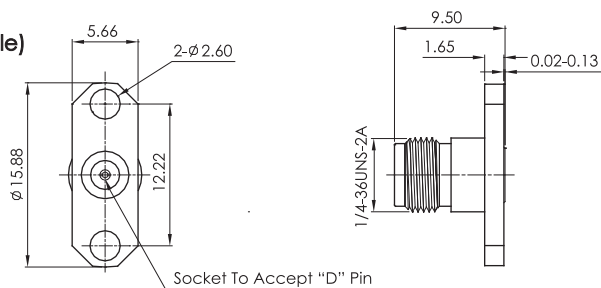

Connector No.	D	MAX. Pin Depth
ANO2912-3057-1	0.23	1.65
ANO2912-3057-2	0.30	1.65
ANO2912-3057-3	0.51	1.65
ANO2912-3057-4	0.38	1.65

2.92mm Plug (Male)

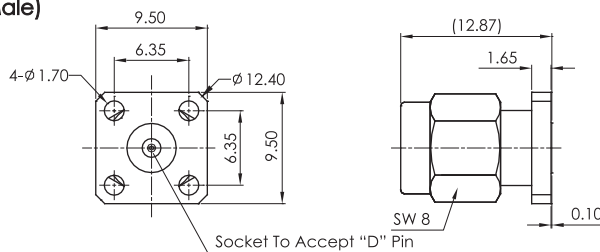

Connector No.	D	MAX. Pin Depth
ANO2911-3013-1	0.23	1.65
ANO2911-3013-2	0.30	1.52
ANO2911-3013-3	0.51	1.65

2.92mm Plug (Male)

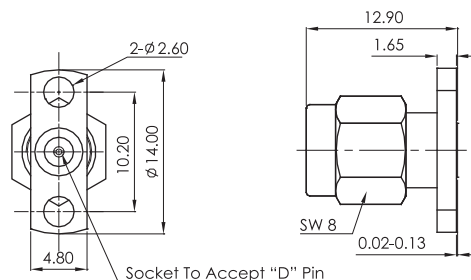

Connector No.	D	MAX. Pin Depth
ANO2911-3053-1	0.23	1.65
ANO2911-3053-2	0.30	1.52
ANO2911-3053-3	0.51	1.65

2.92mm Connectors Series



2.92mm Jack (Female)

Connector No.	D	MAX. Pin Depth
ANO2912-3019-1	0.23	1.65
ANO2912-3019-2	0.30	1.52
ANO2912-3019-3	0.38	1.65

2.92mm Jack (Female)

Connector No.	D	MAX. Pin Depth
ANO2912-3052-1	0.23	1.65
ANO2912-3052-2	0.30	1.52
ANO2912-3052-3	0.38	1.65

2.92mm Jack (Female)

Connector No.	D	MAX. Pin Depth
ANO2912-3062-1	0.23	1.65
ANO2912-3062-2	0.30	1.52
ANO2912-3062-3	0.38	1.65
ANO2912-3062-4	0.51	1.65

2.92mm Jack (Female)

Connector No.	D	MAX. Pin Depth
ANO2912-5036-1	0.23	1.65
ANO2912-5036-2	0.30	1.52
ANO2912-5036-3	0.38	1.65

2.92mm Plug (Male)

Connector No.	D	MAX. Pin Depth
ANO2911-3026-1	0.23	1.65
ANO2911-3026-2	0.30	1.52
ANO2911-3026-3	0.38	1.65
ANO2911-3026-4	0.46	1.65
ANO2911-3026-5	0.51	1.65

2.92mm Connectors Series



2.92mm Plug (Male)

Connector No.	D	MAX. Pin Depth
ANO2911-3054-1	0.23	1.65
ANO2911-3054-2	0.30	1.52
ANO2911-3054-3	0.51	1.65
ANO2911-3054-4	0.38	1.65

2.92mm Plug (Male)

Connector No.	D	MAX. Pin Depth
ANO2911-3055-1	0.23	1.65
ANO2911-3055-2	0.30	1.53
ANO2911-3055-3	0.51	1.65

2.92mm Plug (Male)

Connector No.	D	MAX. Pin Depth	M
ANO2911-5056-1	0.23	1.65	1/4-36UNS-2A
ANO2911-5056-2	0.30	1.65	1/4-36UNS-2A
ANO2911-5056-3	0.51	1.65	1/4-36UNS-2A
ANO2911-5064	0.51	1.65	M6x0.75-6g